



LIFTING SYSTEMS



STAND BEHIND YOUR WORK™

550+ SERVICE CENTERS NATIONWIDE | INDUSTRY-LEADING WARRANTIES | EXPERT TECHNICAL SERVICE

OVER 60 YEARS OF LIFTING SPEED, EFFICIENCY, AND SAFETY



TABLE OF CONTENTS

LIFTING SYSTEMS

AL-100 HAND CHAIN HOIST SERIES	4-7	MANUAL TROLLEYS	30-31
L-100 HAND CHAIN HOIST SERIES	8-11	BEAM CLAMPS	32-33
S-90 HAND CHAIN HOIST SERIES	12-15	VARIABLE SPEED ELECTRIC HOISTS	34-37
JLH COMPACT LEVER HOIST SERIES	16	TWO SPEED ELECTRIC HOISTS	38-39
JLP-A MINI-PULLERS LEVER HOIST SERIES	17	TWO SPEED MOTORIZED TROLLEYS	40-41
JLH LEVER HOIST SERIES	18-21	ELECTRIC HOISTS	42-45
JLA LEVER HOIST SERIES	22-25	CABLE & GRIP PULLERS	46-47
JLP-A LEVER HOIST SERIES	26-29		

JET LIFTING SYSTEMS



HERITAGE

Hoists were the first products JET launched over 60 years ago. Since then JET has sustained a commanding presence in the industry as one of the premiere hoist manufacturers in the U.S. market.

PHILOSOPHY

Since 1958, our philosophy has been, and always will be, to satisfy the needs and demands of our customers.

INNOVATION

JET's extensive research and development results in industry-leading, innovative products that focus on safety and durability.

AL-100 SERIES CHAIN HOISTS

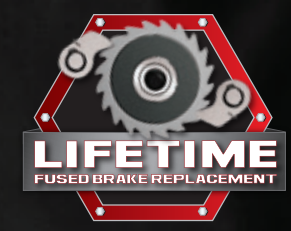

SMALLER AND LIGHTER HOIST

Heavy material just got easier. The AL100 Series is 20% lighter, 20% thinner, and offers the smallest head room compared to the closest competitor on the market.

OVERLOAD PROTECTION MODELS

DUAL PAWL WESTON BRAKE

FUSED BRAKE DESIGN

ALLOY STEEL HOOKS

SAME JET PERFORMANCE

Manual Chain Hoists have been around for decades, with one main advantage: they help lift heavy materials. With the AL100 Series, JET changed the game.

ALL STEEL CONSTRUCTION

HEAT-TREATED LOAD PLATES

GRADE 100 PLATED LOAD CHAIN

CAST-STEEL SAFETY LATCHES

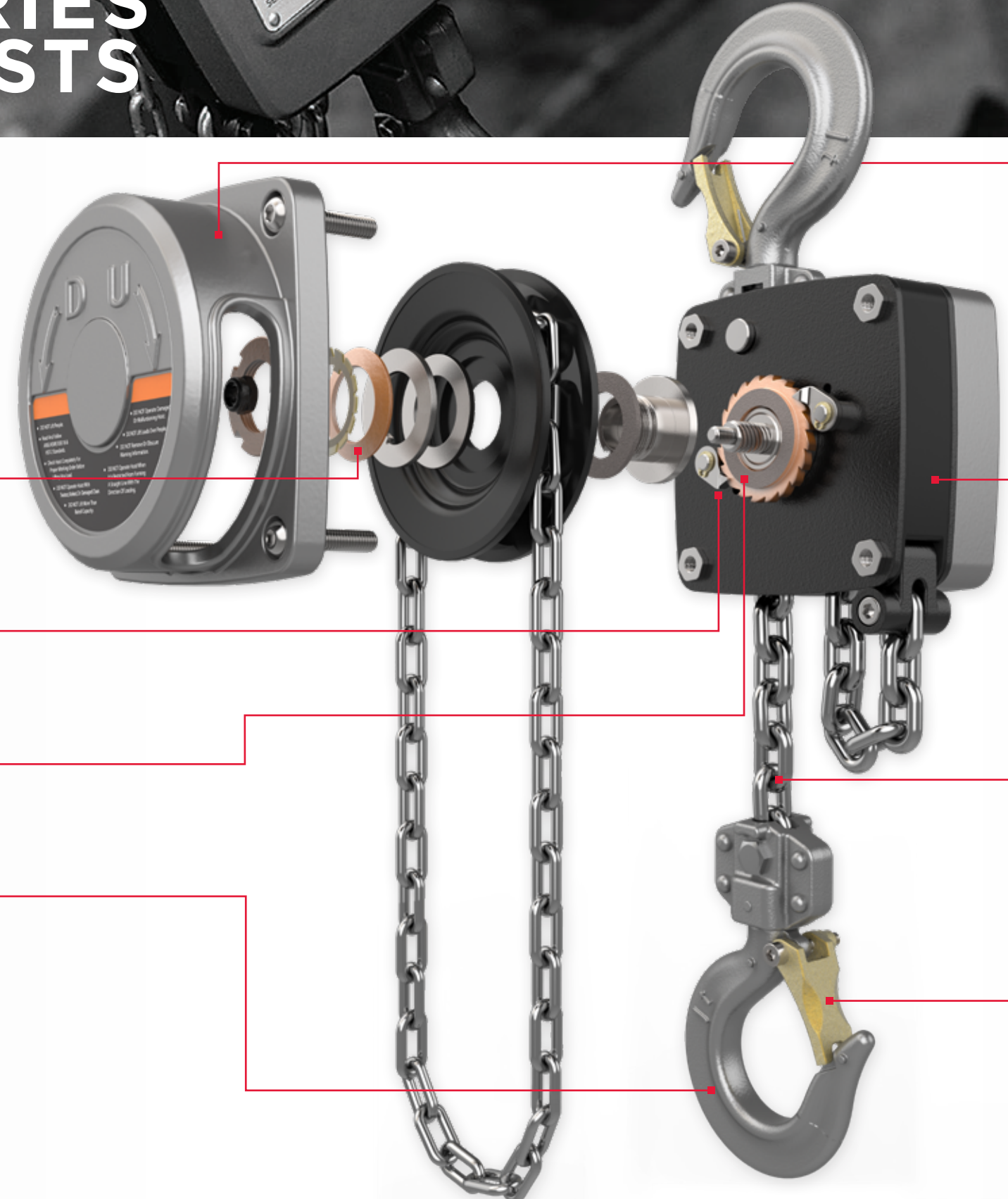



AL-100 SERIES HAND CHAIN HOISTS

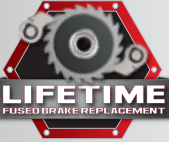

AL-100 SERIES HAND CHAIN HOISTS

SAFETY

- Weston-style Double Pawl System splits the load to opposite sides of the ratchet gear for added safety
- Patented Fused Brake Design provides durability and increases safety backed by a lifetime replacement warranty
- Cast steel safety latches will not bend or deform
- Extra-large hand chain opening for side chain pulling

DURABILITY

- Grade 100 load chain is heat treated for additional strength and zinc plated for corrosion resistance
- Sealed housing provides extra protection against extreme elements

STANDARDS

- Complies with ANSI/ASME B30.16 and HAST-2 Standards



STOCK NUMBER	MODEL NUMBER	CAPACITY (T)	CAPACITY (lbs.)	STANDARD LIFT (ft.)	HEADROOM (in.)	NO. OF FALLS	HAND CHAIN TO LIFT LOAD 1 FT. (ft.)	LBS. OF PULL TO LIFT CAPACITY	WEIGHT (lbs.)
AL-100 SERIES HAND CHAIN HOISTS - 1/2 TON									
133051	AL-100-050-10	1/2	1100	10	10-7/16	1	40	42	10.43
133052	AL-100-050-15	1/2	1100	15	10-7/16	1	40	42	13.42
133053	AL-100-050-20	1/2	1100	20	10-7/16	1	40	42	16.41
133054	AL-100-050-30	1/2	1100	30	10-7/16	1	40	42	22.39
AL-100 SERIES HAND CHAIN HOISTS - 1 TON									
133110	AL-100-100-10	1	2200	10	11-5/8	1	61	53	14.82
133115	AL-100-100-15	1	2200	15	11-5/8	1	61	53	18.65
133120	AL-100-100-20	1	2200	20	11-5/8	1	61	53	22.48
133130	AL-100-100-30	1	2200	30	11-5/8	1	61	53	30.14
AL-100 SERIES HAND CHAIN HOISTS - 1-1/2 TON									
133121	AL-100-150-10	1-1/2	3300	10	13-13/16	1	71	72	27.39
133122	AL-100-150-15	1-1/2	3300	15	13-13/16	1	71	72	34.13
133123	AL-100-150-20	1-1/2	3300	20	13-13/16	1	71	72	40.88
133124	AL-100-150-30	1-1/2	3300	30	13-13/16	1	71	72	54.39
AL-100 SERIES HAND CHAIN HOISTS - 2 TON									
133210	AL100-200-10	2	4400	10	15-3/8	1	90	81	33.07
133215	AL100-200-15	2	4400	15	15-3/8	1	90	81	40.47
133220	AL100-200-20	2	4400	20	15-3/8	1	90	81	47.86
133230	AL100-200-30	2	4400	30	15-3/8	1	90	81	62.64
AL-100 SERIES HAND CHAIN HOISTS - 3 TON									
133310	AL100-300-10	3	6700	10	18-1/2	2	143	114	39.14
133315	AL100-300-15	3	6700	15	18-1/2	2	143	114	49.76
133320	AL100-300-20	3	6700	20	18-1/2	2	143	114	60.37
133330	AL100-300-30	3	6700	30	18-1/2	2	143	114	81.61
AL-100 SERIES HAND CHAIN HOISTS - 5 TON									
133510	AL100-500-10	5	11200	10	22-13/16	2	191	82	66
133515	AL100-500-15	5	11200	15	22-13/16	2	191	82	81.85
133520	AL100-500-20	5	11200	20	22-13/16	2	191	82	97.71
133530	AL100-500-30	5	11200	30	22-13/16	2	191	82	129.43

*CUSTOM LIFTS AVAILABLE IN ALL CAPACITIES IN 10 FT INCREMENTS

AL-100 SERIES HOIST DIMENSIONS (IN.)

CAPACITY	A	B	C	D	E	F	G	H
1/2 TON	3-1/2	3-5/8	1-7/8	1	15/16	1-3/8	1-11/16	10-7/16
1 TON	4	4-5/16	2	1-3/16	1-1/16	1-11/16	1-15/16	11-5/8
1-1/2 TON	4-3/4	5-1/8	2-1/2	1-5/16	1-1/4	1-11/16	2-1/16	13-13/16
2 TON	5-7/16	5-11/16	2-1/2	1-5/16	1-3/8	1-13/16	2-5/16	15-3/8
3 TON	4-3/4	6-1/2	3-3/8	1-7/8	1-7/16	2	2-7/16	18-1/2
5 TON	6-5/16	6-11/16	4-7/16	2-5/16	1-9/16	2-1/2	—	22-13/16

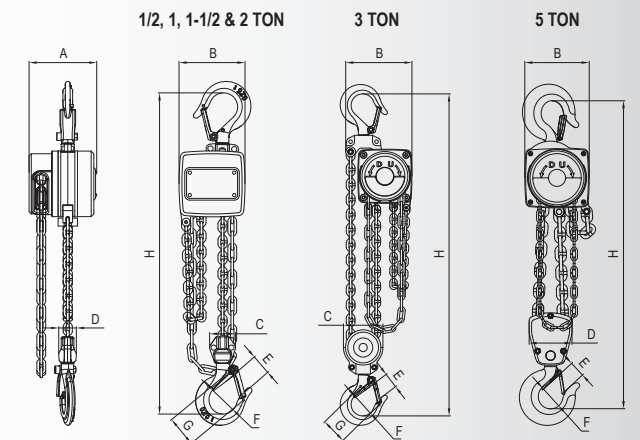

L-100 SERIES CHAIN HOISTS

JET
1½ TON
MODEL NO. L100-150
SERIAL NO. 15062827
JPW Industries LaVergne, TN, U.S.A.
complies with
ANSI/ASME B30.16
ANSI/ASME HST2

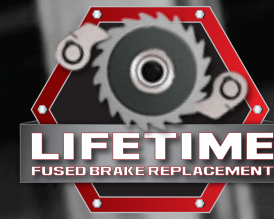

SAFETY COMES STANDARD

JET® hand chain hoists are comprised of the safest and most durable material on the market. Across our full line of hoists, we continue to raise the bar on safety, dependability, and durability.

OVERLOAD PROTECTION MODELS

DUAL PAWL WESTON BRAKE

FUSED BRAKE DESIGN

ALLOY STEEL HOOKS

DURABILITY GUARANTEED

All JET® hand chain hoists are engineered to meet strict tolerances and are constructed with quality materials to ensure they last. JET stands behind these products with industry-leading warranties and support.

ALL STEEL CONSTRUCTION

HEAT-TREATED LOAD PLATES

GRADE 100 PLATED LOAD CHAIN

CAST-STEEL SAFETY LATCHES



L-100 SERIES HAND CHAIN HOISTS



L-100 SERIES HAND CHAIN HOISTS

SAFETY

- Slip clutch style overload protection prevents lifting of damaging loads beyond the rated capacity of the hoist. Overload protection trigger can be reset on site
- Weston-style Double Pawl System splits the load to opposite sides of the ratchet gear for added safety
- Industrial rated alloy steel hooks rotate 360° for easy rigging and slowly stretch to indicate an overload situation
- This product complies with ANSI/ASME B30.16 and HST-2 Standards

DURABILITY

- Grade 100, Zinc-plated load chain provides a smaller, more compact link with a greater working load limit and maximum corrosion resistance
- JET's revolutionary single piece fused brake reduces maintenance and carries a lifetime warranty
- Cast-steel safety latches provide added durability over stamped steel latches and will not bend out of compliance
- Intended for the harshest environments, the heat-treated load plates and case hardened corrosive resistant internal parts extend the life of the hoist and gives industry leading corrosion resistance
- Double sealed ball bearings support the load sheave increasing efficiency by reducing rolling resistance under load, promoting smooth operation
- Impact resistant all steel construction for added durability and protection

VERSATILITY

- Lightweight and smaller body design are ideal for confined areas and low headroom applications
- Load tested to 125% of capacity with certificate



STOCK NUMBER	MODEL NUMBER	CAPACITY (T)	CAPACITY (lbs.)	STANDARD LIFT (ft.)	HEADROOM (in.)	LOAD CHAIN (dia/mm) X NO. OF FALLS	HAND CHAIN TO LIFT LOAD 1 FT. (ft.)	LBS. OF PULL TO LIFT CAPACITY	WEIGHT (lbs.)
L-100 SERIES HAND CHAIN HOISTS WITH OVERLOAD PROTECTION - 1/4 TON									
101200	L-100-250WO-10	1/4	550	10	9-13/16	4 x 1	18	42	10
101225	L-100-250WO-15	1/4	550	15	9-13/16	4 x 1	18	42	12
101250	L-100-250WO-20	1/4	550	20	9-13/16	4 x 1	18	42	14
101223	L-100-250WO-30	1/4	550	30	9-13/16	4 x 1	18	42	16
L-100 SERIES HAND CHAIN HOISTS WITH OVERLOAD PROTECTION - 1/2 TON									
104100	L-100-50WO-10	1/2	1100	10	11-1/4	5 x 1	25	53	24
205115	L-100-50WO-15	1/2	1100	15	11-1/4	5 x 1	25	53	29
205120	L-100-50WO-20	1/2	1100	20	11-1/4	5 x 1	25	53	29
205130	L-100-50WO-30	1/2	1100	30	11-1/4	5 x 1	25	53	44
L-100 SERIES HAND CHAIN HOISTS WITH OVERLOAD PROTECTION - 1 TON									
102100	L-100-100WO-10	1	2200	10	11-5/8	6.3 x 1	43	64	27
203115	L-100-100WO-15	1	2200	15	11-5/8	6.3 x 1	43	64	33
203120	L-100-100WO-20	1	2200	20	11-5/8	6.3 x 1	43	64	39
203130	L-100-100WO-30	1	2200	30	11-5/8	6.3 x 1	43	64	51
L-100 SERIES HAND CHAIN HOISTS WITH OVERLOAD PROTECTION - 1-1/2 TON									
101100	L-100-150WO-10	1-1/2	3300	10	13-3/4	7.1 x 1	57	77	34
201115	L-100-150WO-15	1-1/2	3300	15	13-3/4	7.1 x 1	57	77	41
201120	L-100-150WO-20	1-1/2	3300	20	13-3/4	7.1 x 1	57	77	48
201130	L-100-150WO-30	1-1/2	3300	30	13-3/4	7.1 x 1	57	77	62
L-100 SERIES HAND CHAIN HOISTS WITH OVERLOAD PROTECTION - 2 TON									
105100	L-100-200WO-10	2	4400	10	14-3/4	8 x 1	70	79	44
206115	L-100-200WO-15	2	4400	15	14-3/4	8 x 1	70	79	52
206121	L-100-200WO-20	2	4400	20	14-3/4	8 x 1	70	79	59
206130	L-100-200WO-30	2	4400	30	14-3/4	8 x 1	70	79	75
L-100 SERIES HAND CHAIN HOISTS WITH OVERLOAD PROTECTION - 3 TON									
106100	L-100-300WO-10	3	6600	10	20-1/8	7.1 x 2	114	79	53
207115	L-100-300WO-15	3	6600	15	20-1/8	7.1 x 2	114	79	64
207120	L-100-300WO-20	3	6600	20	20-1/8	7.1 x 2	114	79	74
207130	L-100-300WO-30	3	6600	30	20-1/8	7.1 x 2	114	79	95
L-100 SERIES HAND CHAIN HOISTS WITH OVERLOAD PROTECTION - 5 TON									
107100	L-100-500WO-10	5	11000	10	23-5/8	9 x 2	198	75	90
208115	L-100-500WO-15	5	11000	15	23-5/8	9 x 2	198	75	105
208120	L-100-500WO-20	5	11000	20	23-5/8	9 x 2	198	75	120
208130	L-100-500WO-30	5	11000	30	23-5/8	9 x 2	198	75	149
L-100 SERIES HAND CHAIN HOISTS WITH OVERLOAD PROTECTION - 10 TON									
108100	L-100-1000WO-10	10	22000	10	29-7/8	9 x 4	396	79	174
209115	L-100-1000WO-15	10	22000	15	29-7/8	9 x 4	396	79	200
209120	L-100-1000WO-20	10	22000	20	29-7/8	9 x 4	396	79	227
209130	L-100-1000WO-30	10	22000	30	29-7/8	9 x 4	396	79	279
L-100 SERIES HAND CHAIN HOISTS WITH OVERLOAD PROTECTION - 15 TON									
109110	L-100-1500WO-10	15	33000	10	39-3/8	9 x 6	396 x 2	80 x 2	292
109115	L-100-1500WO-15	15	33000	15	39-3/8	9 x 6	396 x 2	80 x 2	330
109100	L-100-1500WO-20	15	33000	20	39-3/8	9 x 6	396 x 2	80 x 2	369
109130	L-100-1500WO-30	15	33000	30	39-3/8	9 x 6	396 x 2	80 x 2	445
L-100 SERIES HAND CHAIN HOISTS WITH OVERLOAD PROTECTION - 20 TON									
102020	L-100-2000WO-10	20	44000	10	45-1/4	9 x 8	396 x 2	80 x 2	394
108015	L-100-2000WO-15	20	44000	15	45-1/4	9 x 8	396 x 2	80 x 2	447
102000	L-100-2000WO-20	20	44000	20	45-1/4	9 x 8	396 x 2	80 x 2	500
108030	L-100-2000WO-30	20	44000	30	45-1/4	9 x 8	396 x 2	80 x 2	606

*CUSTOM LIFTS AVAILABLE IN ALL CAPACITIES IN 10 FT INCREMENTS

L-100 SERIES HOIST DIMENSIONS (IN.)

CAPACITY	A	B	C	D	E	F	G	H
1/4 TON	3-3/4	4-5/16	1-3/16	13/16	1-1/16	1-1/4	1-3/8	9-13/16
1/2 TON	5-1/8	5-1/2	1-11/16	1	1-1/16	1-1/4	1-3/8	11-1/4
1 TON	6-3/8	6-5/16	2	1-3/16	1-5/16	1-9/16	1-3/4	11-5/8
1-1/2 TON	6-11/16	7-3/16	2-1/2	1-5/16	1-5/16	1-5/8	1-7/8	13-3/4
2 TON	7-1/4	8	2-1/2	1-5/16	1-7/16	1-13/16	2-1/16	14-3/4
3 TON	6-11/16	9-1/4	4-3/16	2-1/16	1-11/16	2-1/16	2-7/16	20-1/16
5 TON	7-9/16	11-1/8	5-1/4	2-1/2	2	2-3/8	3-1/8	23-5/8
10 TON	7-9/16	14-3/16	10-3/8	3-3/4	2-1/2	3-3/8	—	29-15/16
15 TON	8-11/16	19-3/8	4-5/16	6-1/8	3-1/8	3-15/16	—	39-3/8
20 TON	9-1/16	25-13/16	11-1/4	4-13/16	3-1/4	4-5/16	—	45-1/4

1/4, 1/2, 1, 1-1/2 & 2 TON

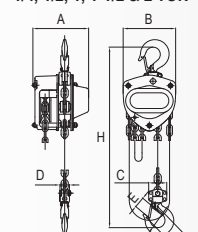

3 & 5 TON

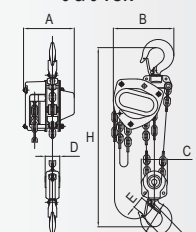

10 TON

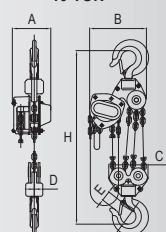

15 TON

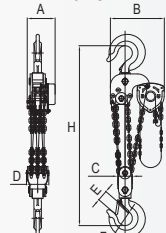

20 TON

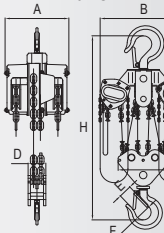

S90 SERIES HAND CHAIN HOISTS



CONTRACTOR- GRADE HOISTS

JET® S90 Series Hand Chain Hoists were designed with all steel construction and ensure reliability and durability to perform in light-duty industrial applications. Easily maintained and serviced, the JET® S90 is available in capacities from 1/2 ton to 10 ton and standard lifts of 10, 15, 20, and 30 feet (custom lifts available).

DUAL PAWL WESTON BRAKE

CAST-STEEL SAFETY LATCHES

ALLOY STEEL HOOKS



GUARANTEED RELIABILITY AND DURABILITY

All JET® hoists are engineered to meet strict tolerances and are constructed with quality materials to ensure they last. JET stands behind these products with industry-leading warranties and support.

ALL STEEL CONSTRUCTION

HEAT-TREATED LOAD PLATES

LOAD CHAIN



S90 SERIES HAND CHAIN HOISTS

S90 SERIES HAND CHAIN HOISTS



SAFETY

- Weston-style Double Pawl System splits the load to opposite sides of the ratchet gear for added safety
- Industrial-rated alloy steel hooks rotate 360° and slowly stretch to indicate overloading
- This product complies with ANSI/ASME B30.16 and HST-2 Standards

DURABILITY

- Grade 80 load chain is black oxide coated for corrosion-resistance
- Intended for the harshest environments, the heat-treated load plates and case hardened corrosive resistant internal parts extend the life of the hoists and gives industry leading corrosion resistance
- Cast-steel safety latches provide added durability over stamped steel latches and will not bend out of compliance
- Needle bearings support the load sheave increasing efficiency by reducing rolling resistance under load, promoting smooth operation
- Impact resistant all steel construction for added durability and protection

STANDARDS

- Lightweight and compact design are ideal for confined areas and low headroom applications
- Load tested to 125% of capacity with certificate

STOCK NUMBER	MODEL NUMBER	CAPACITY (T)	CAPACITY (lbs.)	STANDARD LIFT (ft.)	HEADROOM (in.)	LOAD CHAIN (dia/mm) X NO. OF FALLS	HAND CHAIN TO LIFT LOAD 1 FT. (ft.)	LBS. OF PULL TO LIFT CAPACITY	WEIGHT (lbs.)
S90 SERIES HAND CHAIN HOISTS - 1/2 TON									
101900	S90-050-10	1/2	1100	10	11	5 x 1	32	58	18
101901	S90-050-15	1/2	1100	15	11	5 x 1	32	58	23
101902	S90-050-20	1/2	1100	20	11	5 x 1	32	58	28
101903	S90-050-30	1/2	1100	30	11	5 x 1	32	58	37
S90 SERIES HAND CHAIN HOISTS - 1 TON									
101910	S90-100-10	1	2200	10	12	6 x 1	53	60	25
101911	S90-100-15	1	2200	15	12	6 x 1	53	60	30
101912	S90-100-20	1	2200	20	12	6 x 1	53	60	36
101913	S90-100-30	1	2200	30	12	6 x 1	53	60	47
S90 SERIES HAND CHAIN HOISTS - 1-1/2 TON									
101920	S90-150-10	1-1/2	3300	10	14-1/2	8 x 1	57	84	34
101921	S90-150-15	1-1/2	3300	15	14-1/2	8 x 1	57	84	42
101922	S90-150-20	1-1/2	3300	20	14-1/2	8 x 1	57	84	49
101923	S90-150-30	1-1/2	3300	30	14-1/2	8 x 1	57	84	64
S90 SERIES HAND CHAIN HOISTS - 2 TON									
101930	S90-200-10	2	4400	10	17-1/2	8 x 1	71	91	37
101931	S90-200-15	2	4400	15	17-1/2	8 x 1	71	91	45
101932	S90-200-20	2	4400	20	17-1/2	8 x 1	71	91	52
101933	S90-200-30	2	4400	30	17-1/2	8 x 1	71	91	67
S90 SERIES HAND CHAIN HOISTS - 3 TON									
101940	S90-300-10	3	6600	10	20-1/2	8 x 2	115	87	54
101941	S90-300-15	3	6600	15	20-1/2	8 x 2	115	87	66
101942	S90-300-20	3	6600	20	20-1/2	8 x 2	115	87	78
101943	S90-300-30	3	6600	30	20-1/2	8 x 2	115	87	102
S90 SERIES HAND CHAIN HOISTS - 5 TON									
101950	S90-500-10	5	11000	10	23-1/2	10 x 2	178	90	88
101951	S90-500-15	5	11000	15	23-1/2	10 x 2	178	90	107
101952	S90-500-20	5	11000	20	23-1/2	10 x 2	178	90	125
101953	S90-500-30	5	11000	30	23-1/2	10 x 2	178	90	162
S90 SERIES HAND CHAIN HOISTS - 10 TON									
101960	S90-1000-10	10	22000	10	30	10 x 4	357	96	160
101961	S90-1000-15	10	22000	15	30	10 x 4	357	96	194
101962	S90-1000-20	10	22000	20	30	10 x 4	357	96	228
101963	S90-1000-30	10	22000	30	30	10 x 4	357	96	296

*CUSTOM LIFTS AVAILABLE IN ALL CAPACITIES IN 10 FT INCREMENTS

S90 SERIES HOIST DIMENSIONS (IN.)

CAPACITY	A	B	C	D	E	F	G	H
1/2 TON	5	5-1/8	1-11/16	1	1-1/8	1-5/16	1-3/8	11
1 TON	5-5/16	6-1/8	2	1-3/16	1-5/16	1-5/8	1-13/16	12
1-1/2 TON	6	6-13/16	2-1/2	1-5/16	1-5/16	1-11/16	1-7/8	14-1/2
2 TON	6-3/16	7-5/16	2-1/2	1-5/16	1-1/2	1-13/16	2	17-1/2
3 TON	6-3/16	9-5/16	4	2-3/16	1-11/16	2	2-1/2	20-1/2
5 TON	7-1/8	10-5/16	5	3	2	2-3/8	3-1/8	23-5/8
10 TON	7 1/8	14 3/8	10 3/16	3 7/8	2 1/2	3 5/16	—	30

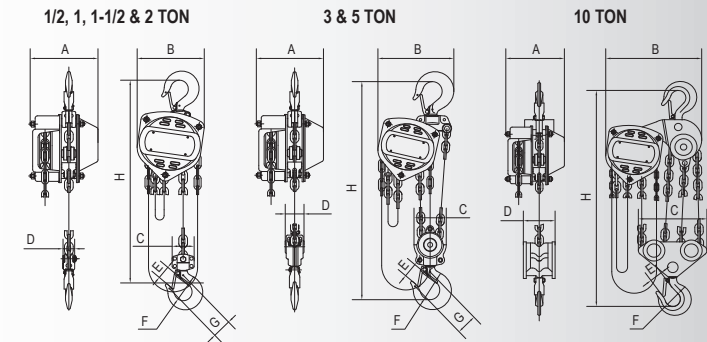



JLH SERIES COMPACT LEVER HOISTS

JLH SERIES COMPACT LEVER HOISTS

SAFETY

- Weston® brake design with opposing double pawls, splits the load to opposite sides of the ratchet gear for greater load security
- Industrial-rated alloy steel hooks rotate 360° and slowly stretch to indicate overloading

DURABILITY

- Grade 100 load chain is a smaller, more compact link with a greater working load limit and is Zinc plated for maximum corrosion protection
- The 4 pocket chain sprocket provides enhanced chain and lift wheel engagement for reduced vibration and smooth lifting
- Secured with Allen screws and lock nuts, the cast-steel safety latches are more durable than stamped steel latches and will not bend out of compliance with lifting regulations
- Durable, impact resistant, aluminum alloy housings
- The heat-treated load plates and case hardened corrosive resistant internal parts extend the life of the hoist
- Rugged vinyl pouch with belt loops and carrying strap included

STANDARDS

- This product complies with ANSI / ASME B30.21 and HST-3 Standards
- Load tested to 125% of capacity with certificate



JLH SERIES HOIST DIMENSIONS (IN.)

CAPACITY	A	B	C	D	E	F	G	H	L
1/4 TON	3-7/16	2-11/16	1-3/16	13/16	13/16	1-1/4	1-3/8	7-7/8	5-3/4
1/2 TON	4	3-3/16	1-7/8	1	1	1-3/8	1-5/8	9-13/16	6-5/16

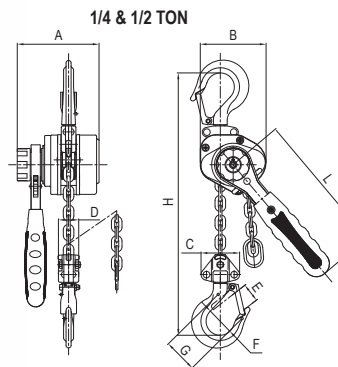

STOCK NUMBER	MODEL NUMBER	CAPACITY (T)	CAPACITY (lbs.)	STANDARD LIFT (ft.)	HEADROOM (in.)	LOAD CHAIN (dia/mm) X NO. OF FALLS	LEVER LENGTH (in.)	LBS. OF PULL TO LIFT CAPACITY	WEIGHT (lbs.)
JLH SERIES LEVER HOISTS - 1/4 TON									
181205	JLH-25-5	1/4	500	5	7-7/8	3.2 x 1	5-3/4	45	3.5
181210	JLH-25-10	1/4	500	10	7-7/8	3.2 x 1	5-3/4	45	4.4
181215	JLH-25-15	1/4	500	15	7-7/8	3.2 x 1	5-3/4	45	5.3
JLH SERIES LEVER HOISTS - 1/2 TON									
181505	JLH-50-5	1/2	1000	5	9-13/16	4.3 x 1	6-5/16	54	5.5
181510	JLH-50-10	1/2	1000	10	9-13/16	4.3 x 1	6-5/16	54	7.0
181515	JLH-50-15	1/2	1000	15	9-13/16	4.3 x 1	6-5/16	54	8.6

*CUSTOM LIFTS AVAILABLE IN ALL CAPACITIES IN 10 FT INCREMENTS

JLP-A SERIES MINI-PULLERS



JLP-A SERIES MINI-PULLERS

SAFETY

- Weston® brake design with opposing double pawls, splits the load to opposite sides of the ratchet gear for greater load security
- Industrial rated alloy steel hooks rotate 360° for easy rigging and slowly stretch to indicate an overload situation

DURABILITY

- Intended for the harshest environments, the heat-treated load plates and case hardened corrosive resistant internal parts extend the life of the hoists and gives industry leading corrosion resistance
- The lightweight design with shorter handle and smaller body are ideal for confined areas and low headroom applications
- Grade 80 load chain is black oxide coated for corrosion resistance
- Impact resistant all steel construction for added durability and protection

STANDARDS

- This product complies with ANSI / ASME B30.21 and HST-3 Standards
- Load tested to 125% of capacity with certificate



JLP-A SERIES HOIST DIMENSIONS (IN.)

CAPACITY	A	B	C	D	E	F	G	H	L
1/4 TON	3-1/8	2-7/16	1-3/4	1	1-3/8	1-1/4	1-3/8	8-1/4	5-15/16
1/2 TON	3-3/4	2-11/16	1-7/8	1	1-3/8	1-3/8	1-5/8	10-1/16	8-7/16

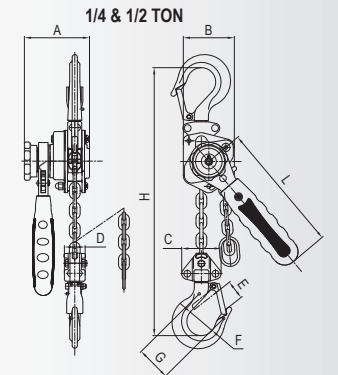

STOCK NUMBER	MODEL NUMBER	CAPACITY (T)	CAPACITY (lbs.)	STANDARD LIFT (ft.)	HEADROOM (in.)	LOAD CHAIN (dia/mm) X NO. OF FALLS	LEVER LENGTH (in.)	LBS. OF PULL TO LIFT CAPACITY	WEIGHT (lbs.)
JLP-A SERIES LEVER HOISTS - 1/4 TON									
287100	JLP-025A-5	1/4	500	5	8-1/4	4 x 1	5-15/16	60	4.6
287101	JLP-025A-10	1/4	500	10	8-1/4	4 x 1	5-15/16	60	5.8
287102	JLP-025A-15	1/4	500	15	8-1/4	4 x 1	5-15/16	60	7.0
JLP-A SERIES LEVER HOISTS - 1/2 TON									
287200	JLP-050A-5	1/2	1000	5	10-1/16	4.3 x 1	8-7/16	86	5.2
287201	JLP-050A-10	1/2	1000	10	10-1/16	4.3 x 1	8-7/16	86	6.8
287202	JLP-050A-15	1/2	1000	15	10-1/16	4.3 x 1	8-7/16	86	8.3

*CUSTOM LIFTS AVAILABLE IN ALL CAPACITIES IN 10 FT INCREMENTS

JLH SERIES LEVER HOISTS

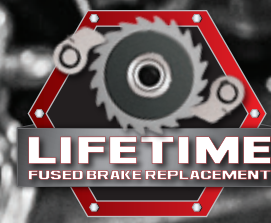

HEAVY-DUTY INDUSTRIAL SOLUTION

JET® lifting systems are comprised of some of the safest and most durable lever hoists for lifting, pulling and holding applications. If you're looking for safety, dependability, and durability, choose JET Lifting Systems.

OVERLOAD PROTECTION

IMPROVED FREE CHAINING

HANDLE DESIGN

IMPROVED GRIP DESIGN

TACKLE SEVERE ENVIRONMENTS

All JET® hoists are engineered to meet strict tolerances and are constructed with quality materials to ensure they last. JET stands behind these products with industry-leading warranties and support.

FUSED BRAKE DESIGN

HEAT-TREATED LOAD PLATES

DOUBLE PAWLS

CAST-STEEL SAFETY LATCHES

ALLOY STEEL HOOKS



JLH SERIES LEVER HOISTS



JLH SERIES LEVER HOISTS

SAFETY

- JET's revolutionary single piece fused brake reduces maintenance and carries a lifetime warranty
- Slip clutch style overload protection prevents lifting of damaging loads beyond the rated capacity of the hoist. Overload protection trigger can be reset on site
- JET's improved easy free chain design is a no-load, two-step free chaining system that permits quicker hoist positioning and take up of slack chain
- Weston-style Double Pawl System splits the load to opposite sides of the ratchet gear for added safety
- This product complies with ANSI / ASME B30.21 and HST-3 Standards

DURABILITY

- Grade 100, Zinc-plated load chain provides a smaller, more compact link with a greater working load limit and maximum corrosion resistance
- Cast-steel safety latches provide added durability over stamped steel latches and will not bend out of compliance
- Intended for the harshest environments, the heat-treated load plates and case hardened corrosive resistant internal parts extend the life of the hoists and gives industry leading corrosion resistance
- Needle bearings support the load sheave increasing efficiency by reducing rolling resistance under load, promoting smooth operation

VERSATILITY

- Redesigned ergonomic grip is secured to the lever arm providing greater operator control and increased comfort
- Advanced offset handle design rotates 360° and allows for extra clearance between the operator's hand and the load chain
- Load tested to 125% of capacity with certificate



STOCK NUMBER	MODEL NUMBER	CAPACITY (T)	CAPACITY (lbs.)	STANDARD LIFT (ft.)	HEADROOM (in.)	LOAD CHAIN (dia/mm) X NO. OF FALLS	LEVER LENGTH (in.)	LBS. OF PULL TO LIFT CAPACITY	WEIGHT (lbs.)
JLH SERIES LEVER HOISTS WITH OVERLOAD PROTECTION- 3/4 TON									
376100	JLH-75WO-5	3/4	1650	5	11	5.6 x 1	10-1/4	64	13
376101	JLH-75WO-10	3/4	1650	10	11	5.6 x 1	10-1/4	64	15
376102	JLH-75WO-15	3/4	1650	15	11	5.6 x 1	10-1/4	64	18
376103	JLH-75WO-20	3/4	1650	20	11	5.6 x 1	10-1/4	64	20
JLH SERIES LEVER HOISTS WITH OVERLOAD PROTECTION- 1 TON									
376200	JLH-100WO-5	1	2200	5	11-13/16	5.6 x 1	10-1/4	79	14
376201	JLH-100WO-10	1	2200	10	11-13/16	5.6 x 1	10-1/4	79	16
376202	JLH-100WO-15	1	2200	15	11-13/16	5.6 x 1	10-1/4	79	18
376203	JLH-100WO-20	1	2200	20	11-13/16	5.6 x 1	10-1/4	79	21
JLH SERIES LEVER HOISTS WITH OVERLOAD PROTECTION- 1-1/2 TON									
376300	JLH-150WO-5	1-1/2	3300	5	13-3/16	7.1 x 1	10-1/4	75	18
376301	JLH-150WO-10	1-1/2	3300	10	13-3/16	7.1 x 1	10-1/4	75	22
376302	JLH-150WO-15	1-1/2	3300	15	13-3/16	7.1 x 1	10-1/4	75	26
376303	JLH-150WO-20	1-1/2	3300	20	13-3/16	7.1 x 1	10-1/4	75	30
JLH SERIES LEVER HOISTS WITH OVERLOAD PROTECTION- 2-1/2 TON									
376400	JLH-250WO-5	2-1/2	5500	5	14-3/4	8.8 x 1	10-1/4	82	25
376401	JLH-250WO-10	2-1/2	5500	10	14-3/4	8.8 x 1	10-1/4	82	31
376402	JLH-250WO-15	2-1/2	5500	15	14-3/4	8.8 x 1	10-1/4	82	36
376403	JLH-250WO-20	2-1/2	5500	20	14-3/4	8.8 x 1	10-1/4	82	42
JLH SERIES LEVER HOISTS WITH OVERLOAD PROTECTION- 3 TON									
376500	JLH-300WO-5	3	6600	5	15-9/16	10 x 1	16-5/16	84	33
376501	JLH-300WO-10	3	6600	10	15-9/16	10 x 1	16-5/16	84	41
376502	JLH-300WO-15	3	6600	15	15-9/16	10 x 1	16-5/16	84	48
376503	JLH-300WO-20	3	6600	20	15-9/16	10 x 1	16-5/16	84	56
JLH SERIES LEVER HOISTS WITH OVERLOAD PROTECTION- 6 TON									
376600	JLH-600WO-5	6	13200	5	21-1/4	10 x 2	16-5/16	84	58
376601	JLH-600WO-10	6	13200	10	21-1/4	10 x 2	16-5/16	84	73
376602	JLH-600WO-15	6	13200	15	21-1/4	10 x 2	16-5/16	84	87
376603	JLH-600WO-20	6	13200	20	21-1/4	10 x 2	16-5/16	84	102
JLH SERIES LEVER HOISTS WITH OVERLOAD PROTECTION- 9 TON									
376700	JLH-900WO-5	9	19800	5	26-13/16	10 x 3	16-5/16	89	95
376701	JLH-900WO-10	9	19800	10	26-13/16	10 x 3	16-5/16	89	118
376702	JLH-900WO-15	9	19800	15	26-13/16	10 x 3	16-5/16	89	140
376703	JLH-900WO-20	9	19800	20	26-13/16	10 x 3	16-5/16	89	163
JLH SERIES LEVER HOISTS WITH SHIP YARD HOOKS AND OVERLOAD PROTECTION- 1-1/2 TON									
376800	JLH-150-5PSH	1-1/2	3300	5	13-13/16	7.1 x 1	10-1/4	75	18
376801	JLH-150-10PSH	1-1/2	3300	10	13-13/16	7.1 x 1	10-1/4	75	22
376802	JLH-150-15PSH	1-1/2	3300	15	13-13/16	7.1 x 1	10-1/4	75	26
376803	JLH-150-20PSH	1-1/2	3300	20	13-13/16	7.1 x 1	10-1/4	75	30
JLH SERIES LEVER HOISTS WITH SHIP YARD HOOKS AND OVERLOAD PROTECTION- 3 TON									
376900	JLH-300-5PSH	3	6600	5	15-9/16	10 x 1	16-5/16	84	34
376901	JLH-300-10PSH	3	6600	10	15-9/16	10 x 1	16-5/16	84	41
376902	JLH-300-15PSH	3	6600	15	15-9/16	10 x 1	16-5/16	84	48
376903	JLH-300-20PSH	3	6600	20	15-9/16	10 x 1	16-5/16	84	56

*CUSTOM LIFTS AVAILABLE IN ALL CAPACITIES IN 10 FT INCREMENTS

JLH SERIES HOIST DIMENSIONS (IN.)

CAPACITY	A	B	C	D	E	F	G	H	L
3/4 TON	5-11/16	4-11/16	2-1/16	1-1/4	1-1/16	1-3/8	1-1/16	11	10-1/4
1 TON	5-11/16	4-11/16	2-1/16	1-1/4	1-1/4	1-11/16	1-1/4	11-13/16	10-1/4
1-1/2 TON	6-3/8	4-15/16	2-11/16	1-3/4	1-3/8	1-11/16	1-3/8	13-3/16	10-1/4
2-1/2 TON	7	5-7/8	3-1/4	1-7/8	1-5/8	1-7/8	1-5/8	14-3/4	10-1/4
3 TON	7-1/2	6-1/4	3-1/4	1-7/8	1-11/16	2	2-7/16	15-9/16	16-5/16
6 TON	7-1/2	8-9/16	4-3/4	2-3/4	2-1/16	2-3/8	3-5/16	21-1/4	16-5/16
9 TON	7-1/2	11-3/4	4-3/4	2-3/4	2-1/2	3-3/8	—	26-13/16	16-5/16

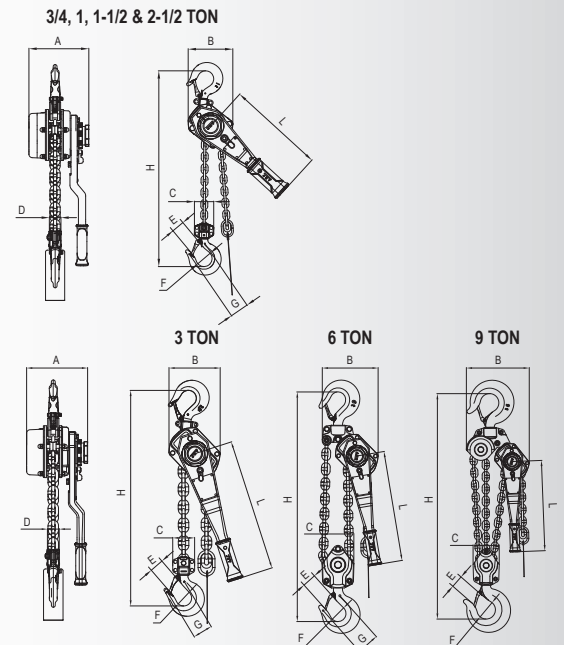

JLA COMPACT LEVER HOISTS

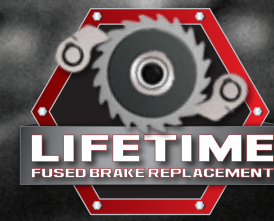

RAISE THE BAR ON LIGHTWEIGHT HOISTS

Raise the bar on lightweight durability with our all-new JLA Compact Lever Hoist! Available in 0.75-ton, 1.5-ton, 3-ton models, this hoist delivers industry-leading size, safety, and durability.

HANDLE DESIGN

IMPROVED GRIP DESIGN

CAST-STEEL SAFETY LATCHES

ALLOY STEEL HOOKS

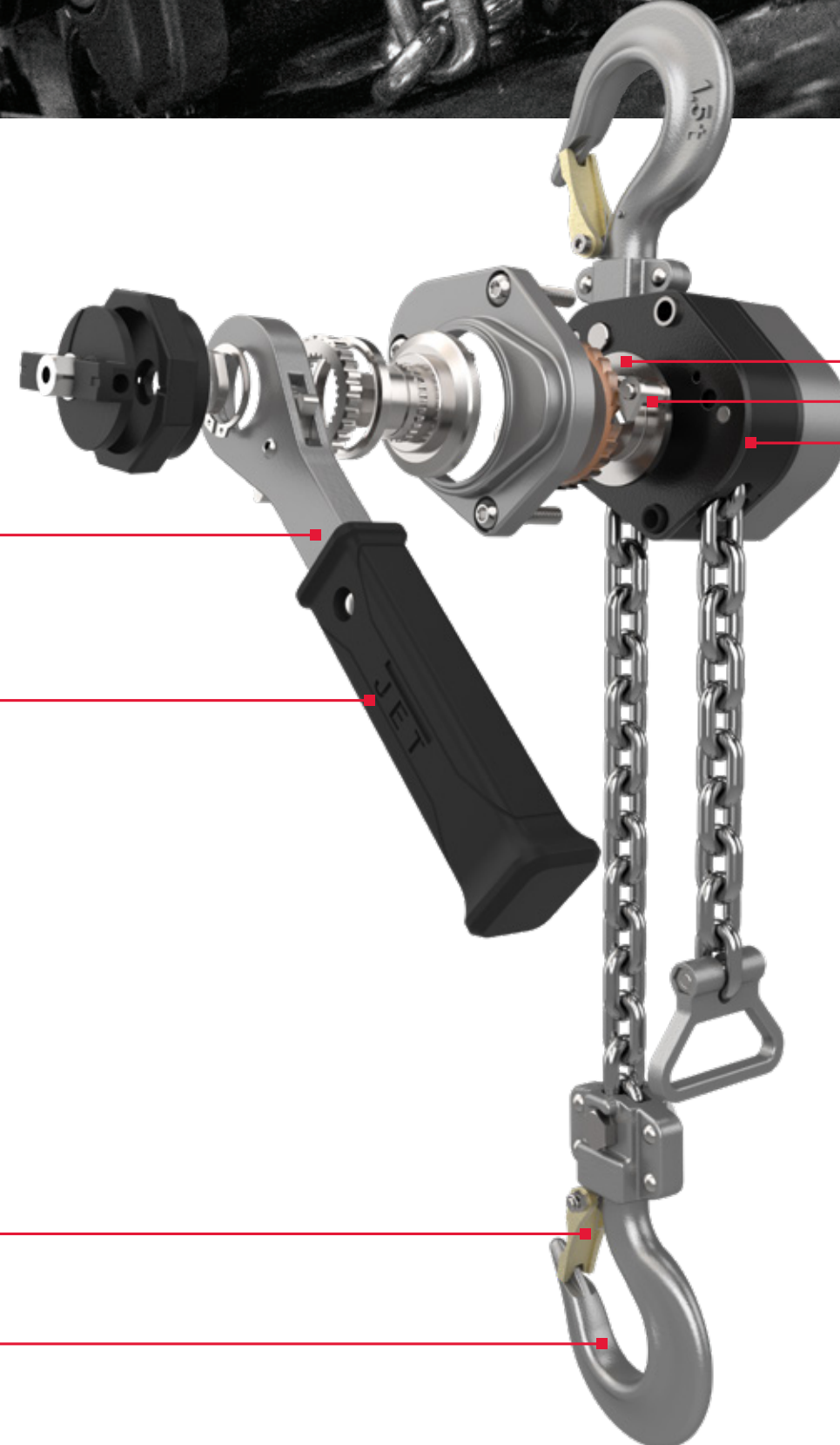

EXPAND YOUR CAPABILITIES

Perfect for your normal, everyday applications, but the JLA series also expands your capabilities with its compact body small enough to fit in your lunchbox, allowing you to get into tight areas where larger body hoists could not.

FUSED BRAKE DESIGN

DOUBLE PAWLS

HEAT-TREATED LOAD PLATES



JLA COMPACT LEVER HOISTS



JLA COMPACT LEVER HOISTS

SAFETY

- Weston-style Double Pawl System splits the load to opposite sides of the ratchet gear for added safety
- Redesigned ergonomic grip provides greater control and increased comfort
- Industrial-rated alloy steel hooks rotate 360° and slowly stretch to indicate overloading
- This product complies with ANSI/ASME B30.21 and HAST-3 Standards

DURABILITY

- World class durability with a 100-grade, Zinc-plated chain
- Cast-steel safety latches provide added durability over stamped steel latches and will not bend out of compliance
- JET's single piece fused brake reduces maintenance and carries a lifetime warranty
- Solid steel, heat-treated load plates for industry leading corrosion resistance

VERSATILITY

- Range in capacity from 3/4 ton to 3 ton
- New free chaining switch for ease-of-use and added efficiency
- Advanced offset handle rotates 360° for extra clearance between the operator's hand and the load chain
- Most compact and light weight lever hoist on the market



STOCK NUMBER	MODEL NUMBER	CAPACITY (T)	CAPACITY (lbs.)	STANDARD LIFT (ft.)	HEADROOM (in.)	LOAD CHAIN (dia/mm) X NO. OF FALLS	LEVER LENGTH (in.)	LBS. OF PULL TO LIFT CAPACITY	WEIGHT (lbs.)
JLA SERIES COMPACT LEVER HOISTS- 3/4 TON									
375305	JLA-75-5	3/4	1650	5	10.24	5.0 x 1	7.09	65	8
375310	JLA-75-10	3/4	1650	10	10.24	5.0 x 1	7.09	65	10
375315	JLA-75-15	3/4	1650	15	10.24	5.0 x 1	7.09	65	12
375320	JLA-75-20	3/4	1650	20	10.24	5.0 x 1	7.09	65	14
JLA SERIES COMPACT LEVER HOISTS- 1-1/2 TON									
375405	JLA-150-5	1-1/2	3300	5	12.99	7.1 x 1	8.66	67	15
375410	JLA-150-10	1-1/2	3300	10	12.99	7.1 x 1	8.66	67	19
375415	JLA-150-15	1-1/2	3300	15	12.99	7.1 x 1	8.66	67	23
375420	JLA-150-20	1-1/2	3300	20	12.99	7.1 x 1	8.66	67	27
JLA SERIES COMPACT LEVER HOISTS- 3 TON									
375505	JLA-300-5	3	6700	5	17.01	7.1 x 2	8.66	75	23
375510	JLA-300-10	3	6700	10	17.01	7.1 x 2	8.66	75	31
375515	JLA-300-15	3	6700	15	17.01	7.1 x 2	8.66	75	39
375520	JLA-300-20	3	6700	20	17.01	7.1 x 2	8.66	75	47
JLA SERIES COMPACT LEVER HOISTS WITH SHIP YARD HOOKS- 1-1/2 TON									
375705	JLA-150-5SH	1-1/2	3300	5	12.99	7.1 x 1	8.66	67	17
375710	JLA-150-10SH	1-1/2	3300	10	12.99	7.1 x 1	8.66	67	21
375715	JLA-150-15SH	1-1/2	3300	15	12.99	7.1 x 1	8.66	67	25
375720	JLA-150-20SH	1-1/2	3300	20	12.99	7.1 x 1	8.66	67	29
JLA SERIES COMPACT LEVER HOISTS WITH SHIP YARD HOOKS- 3 TON									
375805	JLA-300-5SH	3	6700	5	17.01	7.1 x 2	8.66	75	26
375810	JLA-300-10SH	3	6700	10	17.01	7.1 x 2	8.66	75	34
375815	JLA-300-15SH	3	6700	15	17.01	7.1 x 2	8.66	75	42
375820	JLA-300-20SH	3	6700	20	17.01	7.1 x 2	8.66	75	50

*CUSTOM LIFTS AVAILABLE IN ALL CAPACITIES IN 10 FT INCREMENTS

JLA COMPACT HOIST DIMENSIONS (IN.)

CAPACITY	A	B	C	D	E	F	G	H	L
3/4 TON	4-1/2	3-5/8	2-1/16	1-1/4	1-1/8	1-3/8	1-5/8	10-1/4	7-1/16
1-1/2 TON	5-7/16	4-5/16	2-11/16	1-3/4	1-3/8	1-11/16	2-1/16	13	8-11/16
1-1/2 TON (SH)	5-7/16	4-5/16	2-11/16	1-3/4	1-1/4	1-11/16	2	13	8-11/16
3 TON	5-7/16	6-5/16	3-3/8	1-7/8	1-11/16	2	2-7/16	17	8-11/16
3 TON (SH)	5-7/16	6-5/16	3-3/8	1-7/8	1-11/16	2-1/4	2-9/16	17	8-11/16

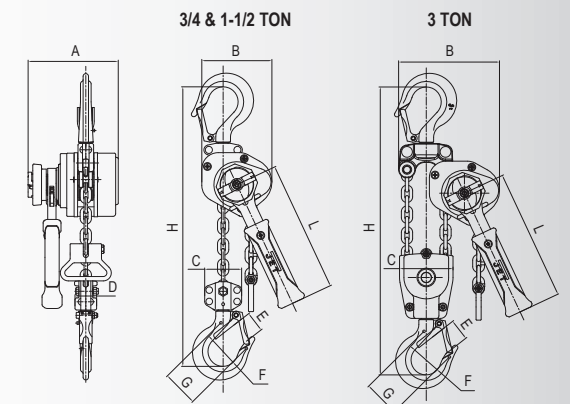

JLP-A SERIES LEVER HOISTS



LIGHT- TO MEDIUM-DUTY SOLUTION

The JLP-A Series of lever hoists exemplifies JET's commitment to delivering the simplest and most cost-effective safety solutions. Designed to create a safer work environment, the JLP-A is the right choice for your lifting or pulling applications.

BRAKE WEAR INDICATOR

CONVENIENT FREE CHAINING

ALL STEEL CONSTRUCTION

IMPROVED GRIP DESIGN



COST-EFFECTIVE AND SAFE

All JET® hoists are engineered to meet strict tolerances and are constructed with quality materials to ensure they last. JET stands behind these products with industry-leading warranties and support.

DUAL PAWL WESTON BRAKE

LOAD CHAIN

CAST-STEEL SAFETY LATCHES

ALLOY STEEL HOOKS



JLP-A SERIES LEVER HOISTS

JLP-A SERIES LEVER HOISTS



SAFETY

- Innovative brake wear indicator provides a visual indication when the friction disks are worn and need replacing
- JET's improved easy free chain design is a no-load, two-step free chaining system that permits quicker hoist positioning and take up of slack chain
- Weston-style Double Pawl System splits the load to opposite sides of the ratchet gear for added safety
- This product complies with ANSI/ASME B30.21 and HST-3 Standards

DURABILITY

- Cast-steel safety latches provide added durability over stamped steel latches and will not bend out of compliance
- Needle bearings support the load sheave increasing efficiency by reducing rolling resistance under load, promoting smooth operation
- Grade 80 load chain is black oxide coated for corrosion resistance
- Impact resistant all steel construction for added durability and protection

VERSATILITY

- Ergonomic grip is secured to the lever arm providing greater operator control and increased comfort
- Handle design rotates 360° allowing for versatile rigging applications in confined environments
- Alloy steel hooks rotate 360° for easy rigging applications, and slowly stretch to indicate an overload situation
- Load tested to 125% of capacity with certificate

STOCK NUMBER	MODEL NUMBER	CAPACITY (T)	CAPACITY (lbs.)	STANDARD LIFT (ft.)	HEADROOM (in.)	LOAD CHAIN (dia/mm) X NO. OF FALLS	LEVER LENGTH (in.)	LBS. OF PULL TO LIFT CAPACITY	WEIGHT (lbs.)
JLP-A SERIES LEVER HOISTS - 3/4 TON									
287300	JLP-075A-5	3/4	1650	5	12-4/5	6 x 1	11-13/16	31	14
287301	JLP-075A-10	3/4	1650	10	12-4/5	6 x 1	11-13/16	31	17
287302	JLP-075A-15	3/4	1650	15	12-4/5	6 x 1	11-13/16	31	19
287303	JLP-075A-20	3/4	1650	20	12-4/5	6 x 1	11-13/16	31	22
JLP-A SERIES LEVER HOISTS - 1-1/2 TON									
287400	JLP-150A-5	1-1/2	3300	5	15	8 x 1	16-1/8	49	25
287401	JLP-150A-10	1-1/2	3300	10	15	8 x 1	16-1/8	49	30
287402	JLP-150A-15	1-1/2	3300	15	15	8 x 1	16-1/8	49	34
287403	JLP-150A-20	1-1/2	3300	20	15	8 x 1	16-1/8	49	39
JLP-A SERIES LEVER HOISTS - 3 TON									
287500	JLP-300A-5	3	6600	5	18-8/9	10 x 1	16-1/8	71	43
287501	JLP-300A-10	3	6600	10	18-8/9	10 x 1	16-1/8	71	50
287502	JLP-300A-15	3	6600	15	18-8/9	10 x 1	16-1/8	71	57
287503	JLP-300A-20	3	6600	20	18-8/9	10 x 1	16-1/8	71	65
JLP-A SERIES LEVER HOISTS - 6 TON									
287600	JLP-600A-5	6	13200	5	24-2/5	10 x 2	16-1/8	77	69
287601	JLP-600A-10	6	13200	10	24-2/5	10 x 2	16-1/8	77	84
287602	JLP-600A-15	6	13200	15	24-2/5	10 x 2	16-1/8	77	98
287603	JLP-600A-20	6	13200	20	24-2/5	10 x 2	16-1/8	77	112
JLP-A SERIES LEVER HOISTS WITH SHIP YARD HOOKS- 1-1/2 TON									
287700	JLP-150A-5SH	1-1/2	3300	5	15	8 x 1	16-1/8	49	20
287701	JLP-150A-10SH	1-1/2	3300	10	15	8 x 1	16-1/8	49	27
287702	JLP-150A-15SH	1-1/2	3300	15	15	8 x 1	16-1/8	49	31
287703	JLP-150A-20SH	1-1/2	3300	20	15	8 x 1	16-1/8	49	39
JLP-A SERIES LEVER HOISTS WITH SHIP YARD HOOKS- 3 TON									
287800	JLP-300A-5SH	3	6600	5	18-8/9	10 x 1	16-1/8	71	43
287801	JLP-300A-10SH	3	6600	10	18-8/9	10 x 1	16-1/8	71	50
287802	JLP-300A-15SH	3	6600	15	18-8/9	10 x 1	16-1/8	71	57
287803	JLP-300A-20SH	3	6600	20	18-8/9	10 x 1	16-1/8	71	63

*CUSTOM LIFTS AVAILABLE IN ALL CAPACITIES IN 10 FT INCREMENTS

JLP-A SERIES HOIST DIMENSIONS (IN.)

CAPACITY	A	B	C	D	E	F	G	H	L
3/4 TON	5-15/16	5-5/16	2	1-3/16	1-1/8	1-3/8	1-7/16	12-13/16	11-13/16
1-1/2 TON	7	6-3/8	2-1/2	1-5/16	1-5/16	1-5/8	1-14/16	14-15/16	16-2/16
3 TON	7-11/16	8-3/16	2-11/16	1-1/2	1-11/16	2-1/16	2-7/16	18-7/8	16-1/8
6 TON	7-11/16	10-1/16	4-15/16	2-13/16	2	2-3/8	3-1/16	24-7/16	16-1/8

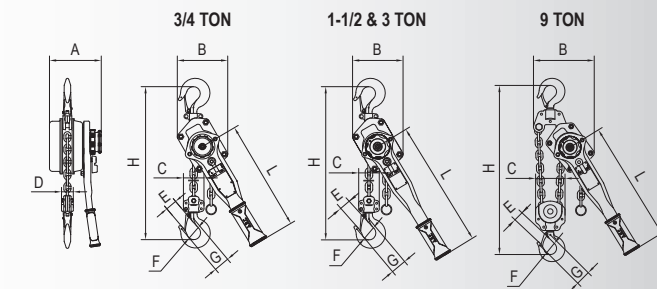

PT SERIES

Our heavy-duty, long-lasting manual trolleys provide smooth movement across a variety of beams in any environment. The added bulk and durability also provide our widest offering of capacities, up to 10 tons.

DURABILITY

- Easily adjustable to wide-flange H-beams, standard I-beams or curved track with the included spacer washers
- Hardened steel wheels and double sealed lubricated ball bearings provide smooth movement
- Welded all-steel frame and powder coat finish provide maximum durability and protection
- Built-in bumper guards increase user safety and extend the life of the trolley

STANDARDS

- This product complies with ANSI / ASME B30.11 and B30.17 Standards
- Load tested to 125% of capacity with certificate



HDT SERIES

This compact line of manual trolleys feature smaller wheels perfect for application with limited head room.

DURABILITY

- Built-in bumper guards on the side plates increase safety and extend trolley life
- Designed for low-maintenance, trouble-free use on wide flange H-beams, standard I-beams, or curved track
- Hardened steel wheels and double-sealed lubricated ball bearings provide smooth movement
- Light weight for maximum versatility

STANDARDS

- This product complies with ANSI / ASME B30.11 and B30.17 Standards
- Load tested to 125% of capacity with certificate

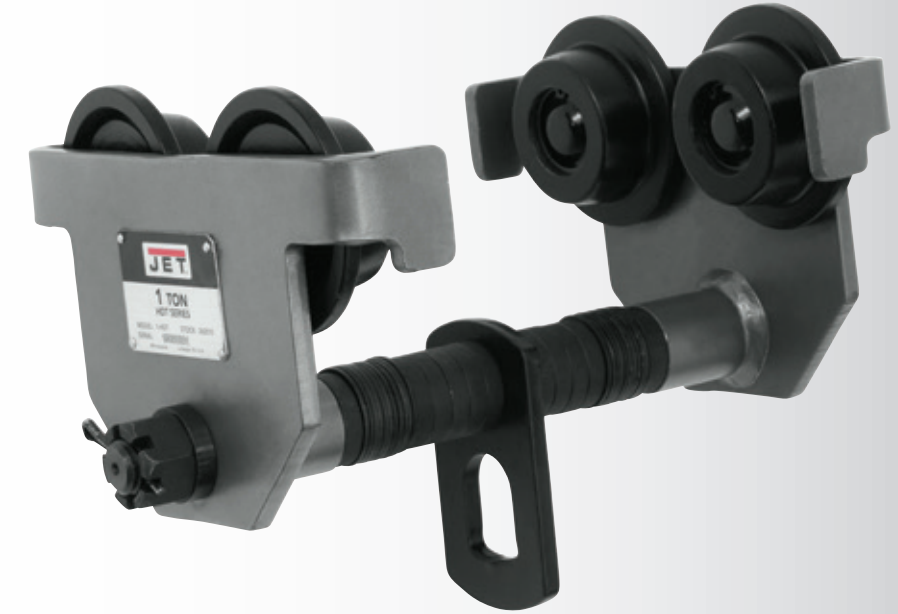

STOCK NUMBER	252005	252010	252015	252020	252030	252050	252060
Model Number	1/2-PT	1-PT	1-1/2-PT	2-PT	3-PT	5-PT	10-PT
Capacity (T)	1/2	1	1-1/2	2	3	5	10
Capacity (lbs.)	1100	2200	3300	4400	6600	11000	22000
Beam Flange Capacity (min. / max / in.)	2-1/2 - 8	3 - 8	3-1/4 - 8	3-1/4 - 8	4 - 8	4-5/8 - 8	4-3/4 - 8
Min. Curve Radius (in.)	39	39	43	43	51	55	67
Beam Height (min. / max / in.)	4 - 19	4 - 19	4 - 19	4 - 19	5 - 19	5 - 19	6 - 19
Wheel Diameter (in.)	2-2/7	3	3-1/3	3-1/2	4-1/3	4-4/5	6
Wheel to Hook Mount (in.)	4-4/9	5	5-5/7	6	7-1/3	8-5/8	10-5/6
Max. Hook Size (W / in.)	15/16	1-1/5	1-1/3	1-3/7	1-7/9	2-1/3	3-2/9
Overall Dimensions (L x W x H / in.)	8-1/3 x 12-2/7 x 5-1/8	10 x 13 x 6	11 x 13-2/9 x 6-3/8	11-8/9 x 13-7/9 x 6-2/3	13-5/8 x 14-4/7 x 8-1/2	15 x 15-3/4 x 10	18 x 17 x 11-3/5
Weight (lbs.)	19	33	41	51	83	120	202

STOCK NUMBER	262005	262010	262020	262030	262050
Model Number	1/2-HDT	1-HDT	2-HDT	3-HDT	5-HDT
Capacity (T)	1/2	1	2	3	5
Capacity (lbs.)	1100	2200	4400	6600	11000
Beam Flange Capacity (min. / max / in.)	2-1/2 - 8	3 - 8	3-1/4 - 8	4 - 8	4-5/8 - 8
Min. Curve Radius (in.)	35	39	43	51	55
Beam Height (min. / max / in.)	3 - 24-1/2	5 - 24-1/2	6 - 24-1/2	8 - 24-1/2	10 - 24-1/2
Wheel Diameter (in.)	2-13/16	2-1/2	3	3-15/16	4-3/4
Wheel to Hook Mount (in.)	4	4-11/16	5-3/8	6-7/16	7-11/16
Max. Hook Size (W / in.)	15/16	1-3/16	1-1/2	1-3/4	2-1/8
Overall Dimensions (L x W x H / in.)	7-3/8 x 11-13/16 x 4-5/8	8-3/8 x 12-1/2 x 5-1/8	10-3/16 x 13 x 6-5/16	12-3/8 x 13-3/4 x 7-7/16	14-13/16 x 14-13/16 x 8-9/16
Weight (lbs.)	11	17	31	51	87

JBC SERIES

Designed to distribute the load away from the beam flange, the JBC series features a more robust construction for increased durability and longer life in demanding industrial environments.

FEATURES

- Welded, fully enclosed pockets provide greater stability and durability where the beam clamp attaches to the beam/structure
- Larger, thicker diameter pins for increased durability and life

DURABILITY

- Welded all-steel frame and powder coat finish provide maximum durability and protection
- Clamp jaw is designed to distribute the load away from the beam flange edge increasing safety
- Used for quick mounting of a hoist to a broad range of beams

STANDARDS

- This product complies with ANSI / ASME B30.11 and B30.17 Standards
- Load tested to 125% of capacity with certificate



HD SERIES

Available in up to 5-ton capacities, the HD Series has a large-capacity beam flange width to handle wider beams at a lighter weight than most beam clamps.

FEATURES

- Wider beam capacity able tackle beams up to 12 inches wide
- Lighter weight than our JBC Series
- Clamp jaw design distributes load away from the beam flange edge for added safety

DURABILITY

- Welded all-steel frame and powder coat finish provide maximum durability and protection
- Twin reinforcing clamp jaw pins for increased clamping stability and durability

STANDARDS

- This product complies with ANSI / ASME B30.11 and B30.17 Standards
- Load tested to 125% of capacity with certificate

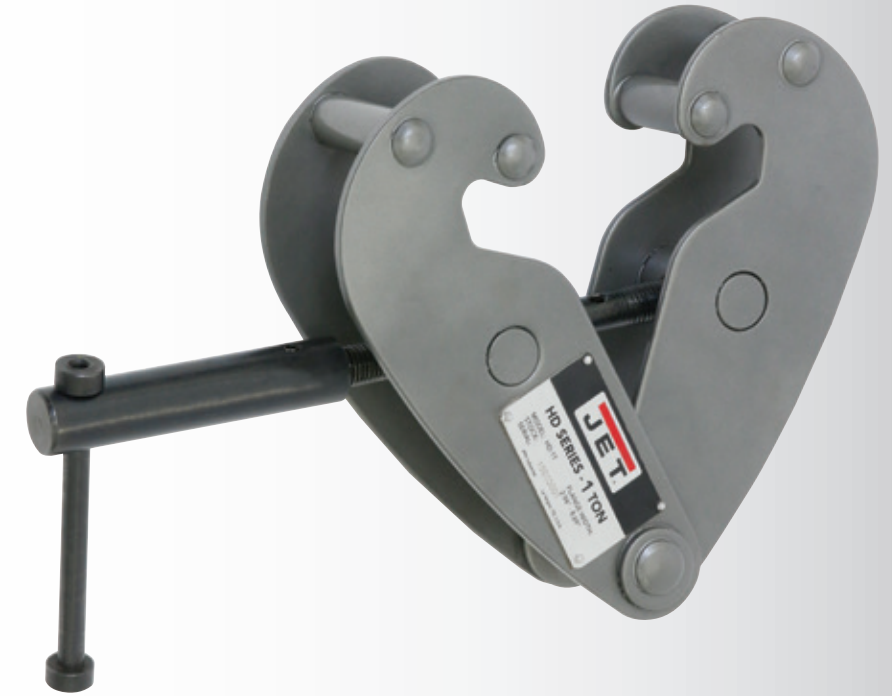

STOCK NUMBER	252710	252720	252730	252750
Model Number	JBC-1	JBC-2	JBC-3	JBC-5
Capacity (T)	1	2	3	5
Capacity (lbs.)	2200	4400	6600	11000
Beam Flange Capacity (min. / max / in.)	2-31/32 - 8-5/8	2-31/32 - 8-5/8	3-15/16 - 9-5/8	4-15/16 - 10-5/8
Weight (lbs.)	12	14	27	34

STOCK NUMBER	202710	202720	202730	202750
Model Number	HD-1T	HD-2T	HD-3T	HD-5T
Capacity (T)	1	2	3	5
Capacity (lbs.)	2200	4400	6600	11000
Beam Flange Capacity (min. / max / in.)	2-15/16 - 8-11/16	2-15/16 - 8-11/16	3-1/8 - 12-5/8	3-9/16 - 12-5/8
Weight (lbs.)	10	11	21	24

TRADEMASTER SERIES BRUSHLESS VARIABLE SPEED ELECTRIC HOISTS



SAFETY COMES STANDARD

JET Trademaster® Series Electric Hoists combines safety, portability, and durability to operate in all your industrial, construction, and transportation applications. With its market leading wireless controller and 2 in 1 mechanical brake and overload slip clutch, safety is most important. The Trademaster® Series comes in 1/8-Ton to 2-Ton capacities and standard lifts of 10 and 20ft (custom lifts up to 100ft are available).

DC BRUSHLESS MOTOR

5 POCKET LOAD SHEAVE

GEAR LIMIT SWITCH

THERMAL OVERLOAD PROTECTION

OVERLOAD PROTECTION

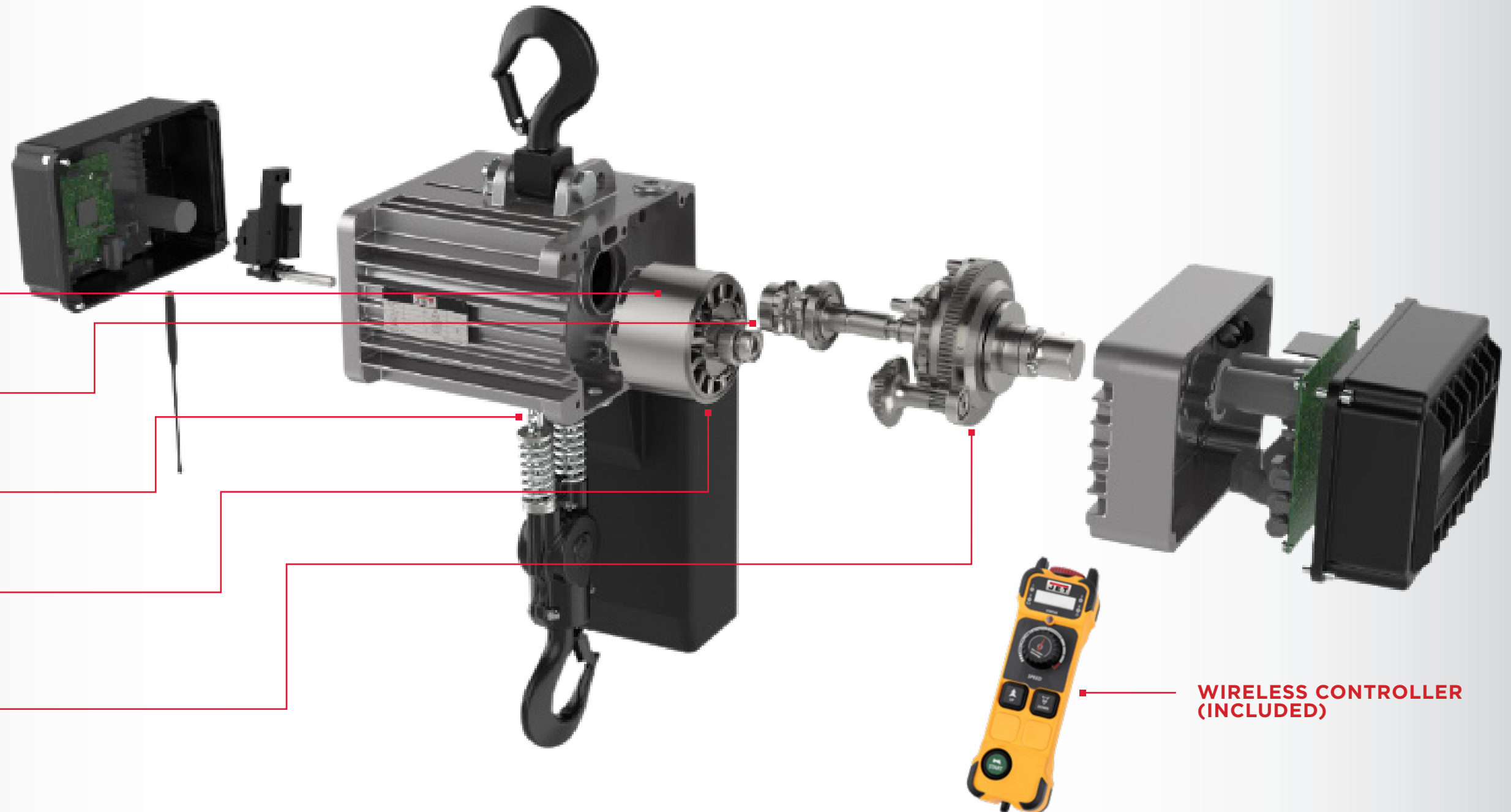

WIRELESS CONTROLLER (INCLUDED)



TRADEMASTER SERIES BRUSHLESS VARIABLE SPEED ELECTRIC HOISTS

SAFETY

- Overload protection using slip clutch system to protect hoist from loads exceeding rated capacities
- Electronic controls are protected by 10 failure codes that are shown on wireless pendant for troubleshooting

DURABILITY

- DC Brushless motor designed for a longer lifespan than normal electric hoist motors, drastically reducing maintenance costs
- Lightweight, compact housing gets you into those tight areas while allowing you transport it from job to job in its molded carrying case

VERSATILITY

- Single phase 120V plug enables use in all areas and the Permanent Magnet Brushless Motor has the lowest required starting current available at just 10 amp
- Comes standard with Wireless Controller that can infinitely adjust speed from creep to 5.3ft/min with speed dial and a max of 21ft/min in high speed
- TAA Approved



STOCK NUMBER	MODEL NUMBER	CAPACITY (T)	CAPACITY (lbs.)	LIFT (ft.)	LIFTING SPEED (fpm)		MOTOR OUTPUT (hp)	VOLTAGE	AMP DRAW	NO. PHASE	LOAD CHAIN DIAMETER (mm) x NO. OF FALLS	DUTY RATING	TIME RATING PER HOUR (min.)	MAX STARTS PER HOUR	HEADROOM (in.)	WEIGHT (lbs.)
					LOW	HIGH										
TRADEMASTER SERIES ELECTRIC HOISTS - SINGLE PHASE - 1/8 TON																
104000	BLVS018-010	1/8	250	10	4.1-10.5	41	0.4	115	6.0	1	4 x 1	H3	15	180	15.7	36
104002	BLVS018-020	1/8	250	20	4.1-10.5	41	0.4	115	6.0	1	4 x 1	H3	15	180	15.7	39
TRADEMASTER SERIES ELECTRIC HOISTS - SINGLE PHASE - 1/4 TON																
104011	BLVS025-010	1/4	550	10	4.1-10.5	41	0.8	115	10.0	1	4 x 1	H3	15	180	15.7	36
104013	BLVS025-020	1/4	550	20	4.1-10.5	41	0.8	115	10.0	1	4 x 1	H3	15	180	15.7	39
TRADEMASTER SERIES ELECTRIC HOISTS - SINGLE PHASE - 1/2 TON																
104022	BLVS050-010	1/2	1100	10	2.07-5.25	20.67	0.8	115	10.0	1	4 x 2	H3	15	180	19.4	43
104024	BLVS050-020	1/2	1100	20	2.07-5.25	20.67	0.8	115	10.0	1	4 x 2	H3	15	180	19.4	47
TRADEMASTER SERIES ELECTRIC HOISTS - SINGLE PHASE - 1 TON																
104033	BLVS100-010	1	2200	10	1.84-4.59	18.4	1.34	115	15.0	1	7.1 x 1	H3	15	180	20.7	118
104035	BLVS100-020	1	2200	20	1.84-4.59	18.4	1.34	115	15.0	1	7.1 x 1	H3	15	180	20.7	128
TRADEMASTER SERIES ELECTRIC HOISTS - SINGLE PHASE - 2 TON																
104044	BLVS200-010	2	4400	10	0.92-2.3	9.18	1.34	115	15.0	1	7.1 x 2	H3	15	180	20.7	127
104046	BLVS200-020	2	4400	20	0.92-2.3	9.18	1.34	115	15.0	1	7.1 x 2	H3	15	180	20.7	153

*CUSTOM LIFTS AVAILABLE IN ALL CAPACITIES IN 5 FT. INCREMENTS

TRADEMASTER HOIST DIMENSIONS (IN.)

CAPACITY	A	B	C	D
1/8 TON	15.7	10.3	4.3	14.4
1/4 TON	15.7	10.3	4.3	14.4
1/2 TON	19.4	10.3	3.4	14.4
1 TON	20.7	15.3	7	20.9
2 TON	20.7	15.3	7	20.9

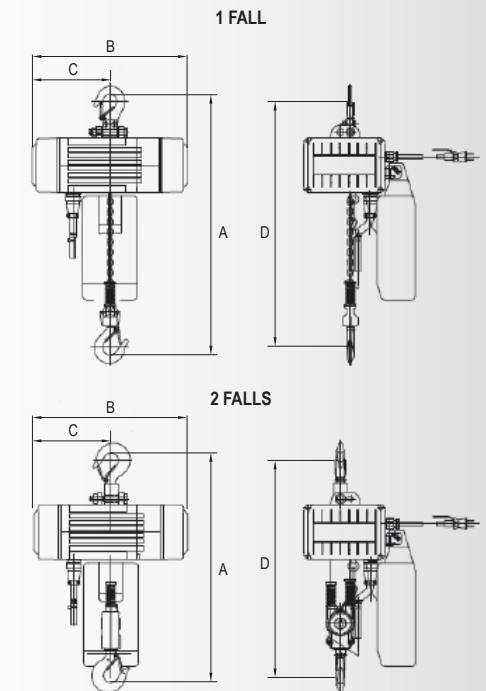



TS SERIES ELECTRIC HOISTS

TS SERIES TWO SPEED ELECTRIC HOISTS



SAFETY

- Two-in-one mechanical brake and overload protection assures you of safety first on the jobsite.
- DC Motor Brake actuates instantly in the event of a power failure to ensure operator safety.

DURABILITY

- Built-in heat protection will not allow lifting if internal temperatures exceed 285° F (+/-40°). Easily lower the load until the unit cools to extend the life of internal components.
- IP55 TEFC Motor with Class F insulation for working in harsh environments.
- Pendant Control is IP65 rated and is fully waterproof, insulated, and impact resistant for years of service.

VERSATILITY

- Lifting speeds from 3 feet per minute up to 33 feet per minute gives you the ability to be more efficient with every load.
- Patented gear limit switch provides precise control of the stopping point in both directions, prolonging the life of the hoist by avoiding damage to the unit.

TS SERIES PENDANT CONTROLS

STOCK NUMBER	DESCRIPTION
104055	WIRED PENDANT, 2-BTN, TS, 11FT
104056	WIRED PENDANT, 2-BTN, TS, 16FT
104057	WIRED PENDANT, 2-BTN, TS, 6FT
140196	WIRED PENDANT, 4-BTN, TS+MT, 11FT
140197	WIRED PENDANT, 4-BTN, TS+MT, 16FT
140198	WIRED PENDANT, 4-BTN, TS+MT, 6FT

STOCK NUMBER	MODEL NUMBER	CAPACITY (T)	CAPACITY (lbs.)	NO. FAILS	LIFT (ft.)	LIFTING SPEED (fpm) LOW / HIGH	MOTOR	AMP DRAW (A) LOW / HIGH	HEADROOM (in.)	CLASSIFICATION	TIME RATING (min.) LOW / HIGH	WEIGHT (lbs.)
TS SERIES ELECTRIC HOISTS - 230V 3-PHASE - 1/2 TON												
140233	TS050-230-010	1/2	1100	1	10	8 / 33	0.4 / 1.5HP, 230V 3PH	4 / 6.9	19.7	H4	7.5 / 30	117
140234	TS050-230-015	1/2	1100	1	15	8 / 33	0.4 / 1.5HP, 230V 3PH	4 / 6.9	19.7	H4	7.5 / 30	121
140235	TS050-230-020	1/2	1100	1	20	8 / 33	0.4 / 1.5HP, 230V 3PH	4 / 6.9	19.7	H4	7.5 / 30	125
TS SERIES ELECTRIC HOISTS - 230V 3-PHASE - 1 TON												
140236	TS100-230-010	1	2,200	1	10	7 / 26	0.5 / 2.0HP, 230V 3PH	5.6 / 11	21.7	H4	7.5 / 30	163
140237	TS100-230-015	1	2,200	1	15	7 / 26	0.5 / 2.0HP, 230V 3PH	5.6 / 11	21.7	H4	7.5 / 30	168
140238	TS100-230-020	1	2,200	1	20	7 / 26	0.5 / 2.0HP, 230V 3PH	5.6 / 11	21.7	H4	7.5 / 30	172
TS SERIES ELECTRIC HOISTS - 230V 3-PHASE - 2 TON												
140239	TS200-230-010	2	4,400	1	10	8 / 32	1.2 / 5.0HP, 230V 3PH	8.4 / 16.8	40.2	H4	7.5 / 30	320
140094	TS200-230-015	2	4,400	1	15	8 / 32	1.2 / 5.0HP, 230V 3PH	8.4 / 16.8	40.2	H4	7.5 / 30	328
140240	TS200-230-020	2	4,400	1	20	8 / 32	1.2 / 5.0HP, 230V 3PH	8.4 / 16.8	40.2	H4	7.5 / 30	336
TS SERIES ELECTRIC HOISTS - 230V 3-PHASE - 3 TON												
140116	TS300-230-010	3	6,600	2	10	5 / 21	1.2 / 5.0HP, 230V 3PH	8.4 / 16.8	41.3	H4	7.5 / 30	351
140117	TS300-230-015	3	6,600	2	15	5 / 21	1.2 / 5.0HP, 230V 3PH	8.4 / 16.8	41.3	H4	7.5 / 30	366
140118	TS300-230-020	3	6,600	2	20	5 / 21	1.2 / 5.0HP, 230V 3PH	8.4 / 16.8	41.3	H4	7.5 / 30	382
TS SERIES ELECTRIC HOISTS - 230V 3-PHASE - 5 TON												
140127	TS500-230-010	5	11,000	2	10	3 / 13	1.2 / 5.0HP, 230V 3PH	8.4 / 16.8	43.3	H4	7.5 / 30	373
140128	TS500-230-015	5	11,000	2	15	3 / 13	1.2 / 5.0HP, 230V 3PH	8.4 / 16.8	43.3	H4	7.5 / 30	391
140129	TS500-230-020	5	11,000	2	20	3 / 13	1.2 / 5.0HP, 230V 3PH	8.4 / 16.8	43.3	H4	7.5 / 30	410
TS SERIES ELECTRIC HOISTS - 460V 3-PHASE - 1/2 TON												
144001	TS050-460-010	1/2	1100	1	10	8 / 33	0.4 / 1.5HP, 460V 3PH	2 / 3.5	19.7	H4	7.5 / 30	117
144002	TS050-460-015	1/2	1100	1	15	8 / 33	0.4 / 1.5HP, 460V 3PH	2 / 3.5	19.7	H4	7.5 / 30	121
144003	TS050-460-020	1/2	1100	1	20	8 / 33	0.4 / 1.5HP, 460V 3PH	2 / 3.5	19.7	H4	7.5 / 30	125
TS SERIES ELECTRIC HOISTS - 460V 3-PHASE - 1 TON												
144004	TS0100-460-010	1	2,200	1	10	7 / 26	0.5 / 2.0HP, 460V 3PH	2.8 / 5.5	21.7	H4	7.5 / 30	163
144005	TS0100-460-015	1	2,200	1	15	7 / 26	0.5 / 2.0HP, 460V 3PH	2.8 / 5.5	21.7	H4	7.5 / 30	168
144006	TS0100-460-020	1	2,200	1	20	7 / 26	0.5 / 2.0HP, 460V 3PH	2.8 / 5.5	21.7	H4	7.5 / 30	172
TS SERIES ELECTRIC HOISTS - 460V 3-PHASE - 2 TON												
144007	TS0200-460-010	2	4,400	1	10	8 / 32	1.2 / 5.0HP, 460V 3PH	4.2 / 8.4	40.2	H4	7.5 / 30	320
144008	TS0200-460-015	2	4,400	1	15	8 / 32	1.2 / 5.0HP, 460V 3PH	4.2 / 8.4	40.2	H4	7.5 / 30	328
144009	TS0200-460-020	2	4,400	1	20	8 / 32	1.2 / 5.0HP, 460V 3PH	4.2 / 8.4	40.2	H4	7.5 / 30	336
TS SERIES ELECTRIC HOISTS - 460V 3-PHASE - 3 TON												
144010	TS300-460-010	3	6,600	2	10	5 / 21	1.2 / 5.0HP, 460V 3PH	4.2 / 8.4	41.3	H4	7.5 / 30	351
144011	TS300-460-015	3	6,600	2	15	5 / 21	1.2 / 5.0HP, 460V 3PH	4.2 / 8.4	41.3	H4	7.5 / 30	366
144012	TS300-460-020	3	6,600	2	20	5 / 21	1.2 / 5.0HP, 460V 3PH	4.2 / 8.4	41.3	H4	7.5 / 30	382
TS SERIES ELECTRIC HOISTS - 460V 3-PHASE - 5 TON												
144013	TS500-460-010	5	11,000	2	10	3 / 13	1.2 / 5.0HP, 460V 3PH	4.2 / 8.4	43.3	H4	7.5 / 30	373
144014	TS500-460-015	5	11,000	2	15	3 / 13	1.2 / 5.0HP, 460V 3PH	4.2 / 8.4	43.3	H4	7.5 / 30	391
144015	TS500-460-020	5	11,000	2	20	3 / 13	1.2 / 5.0HP, 460V 3PH	4.2 / 8.4	43.3	H4	7.5 / 30	410

*CUSTOM LIFTS AVAILABLE IN ALL CAPACITIES IN 5 FT. INCREMENTS

TS SERIES HOIST DIMENSIONS

	A	B	C	D	E	F	G	H1	H2
TS050	22-4/9	10-5/8	12-1/5	6-1/2	14-3/4	7-1/2	7-2/7	19-2/3	—
TS100	24-2/5	11-4/5	12-3/5	7	16-1/7	7-2/3	8-2/3	21-2/3	—
TS200	28-1/7	13-2/5	14-3/4	8-2/3	20-7/8	10-5/8	10-1/4	40-1/6	—
TS300	28-1/7	13-2/5	14-3/4	8-2/3	20-7/8	10-5/8	10-1/4	—	41-1/3
TS500	28-1/7	13-2/5	14-3/4	8-2/3	20-7/8	10-5/8	10-1/4	—	43-1/3
TS050-4	22-4/9	10-5/8	12-1/5	6-1/2	14-3/4	7-1/2	7-2/7	19-2/3	—
TS100-4	24-2/5	11-4/5	12-3/5	7	16-1/7	7-2/3	8-2/3	21-2/3	—
TS200-4	28-1/7	13-2/5	14-3/4	8-2/3	20-7/8	10-5/8	10-1/4	40-1/6	—
TS300-4	28-1/7	13-2/5	14-3/4	8-2/3	20-7/8	10-5/8	10-1/4	—	41-1/3
TS500-4	28-1/7	13-2/5	14-3/4	8-2/3	20-7/8	10-5/8	10-1/4	—	43-1/3

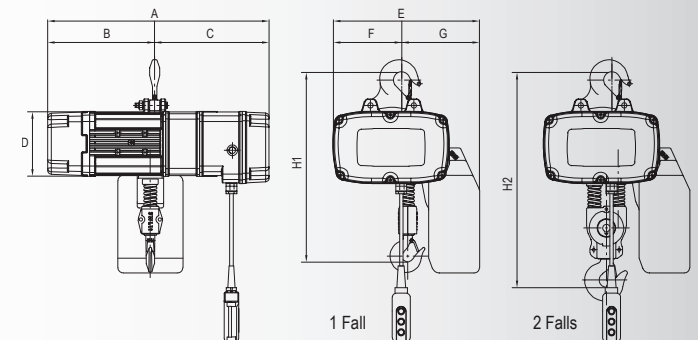



MT SERIES MOTORIZED TROLLEYS

MT SERIES TWO SPEED MOTORIZED TROLLEYS

SAFETY

- Two speeds so you can move material quickly and safely, while also being able to place your load precisely without excessive bump firing
- Safe travel speeds from 20 feet per minute to 79 feet per minute allowing you to be more efficient with every load

DURABILITY

- Heavy-duty motor puts out up to 0.8HP, making it the strongest in its class
- Indoor and Outdoor use with IP-55 rating for trolley and IP-65 rating for the pendant

VERSATILITY

- The MT series trolley is available from 1/2 Ton to 5 Ton capacities
- Expanded flange capacity kits are available
- TAA approved

HOIST ACCESSORIES PENDANT CONTROLS

FEATURES

- NEMA 4X enclosures provide a higher degree of protection against corrosive elements when exposed to extreme and harsh environments
- 24-volt push button controller with cable strain relief system for electric hoist or trolley feature 4-pin quick connect plugs
- Water tight, dust tight and corrosion-resistant for NEMA 4X rated control pendant suitable for indoor and outdoor applications



STOCK NUMBER	152411	152416	152421	152431
Model Number	PBC-410CN	PBC-415CN	PBC-420CN	PBC-430CN
Control Type	4 Button	4 Button	4 Button	4 Button
Cord Length (ft.)	10	15	20	30

STOCK NUMBER	MODEL NUMBER	CAPACITY (T)	CAPACITY (lbs.)	TRAVEL SPEED (fpm) LOW / HIGH	BEAM FLANGE	MIN. CURVE	WHEEL DIA. (in.)	WHEEL TO HOOK	MOTOR	WEIGHT (lbs.)
MT SERIES MOTORIZED TROLLEY - 230V 3-PHASE - 1/2-TON										
140183	MT050	1/2	1100	20 / 79	3-5	51.2	7/8	3.7	0.04 / 0.16HP, 230V 3PH	99
MT SERIES MOTORIZED TROLLEY - 230V 3-PHASE - 1-TON										
140185	MT100	1	2,200	20 / 79	3-5	51.2	1	3.7	0.05 / 0.24HP, 230V 3PH	99
MT SERIES MOTORIZED TROLLEY - 230V 3-PHASE - 2-TON										
140187	MT200	2	4,400	20 / 79	4-6	66.9	1-1/4	3.8	0.12 / 0.49HP, 230V 3PH	126
MT SERIES MOTORIZED TROLLEY - 230V 3-PHASE - 3-TON										
140189	MT300	3	6,600	20 / 79	5-7	78.7	1-1/2	5.0	0.2 / 0.8HP, 230V 3PH	196
MT SERIES MOTORIZED TROLLEY - 230V 3-PHASE - 5-TON										
140190	MT500	5	11,000	20 / 79	5-7	78.7	1-3/4	5.0	0.2 / 0.8HP, 230V 3PH	196
MT SERIES MOTORIZED TROLLEY - 460V 3-PHASE - 1/2-TON										
144183	MT050-4	1/2	1100	20 / 79	3-5	51.2	7/8	3.7	0.04 / 0.16HP, 460V 3PH	99
MT SERIES MOTORIZED TROLLEY - 460V 3-PHASE - 1-TON										
144185	MT100-4	1	2,200	20 / 79	3-5	51.2	1	3.7	0.05 / 0.24HP, 460V 3PH	99
MT SERIES MOTORIZED TROLLEY - 460V 3-PHASE - 2-TON										
144187	MT200-4	2	4,400	20 / 79	4-6	66.9	1-1/4	3.8	0.12 / 0.49HP, 460V 3PH	126
MT SERIES MOTORIZED TROLLEY - 460V 3-PHASE - 3-TON										
144189	MT300-4	3	6,600	20 / 79	5-7	78.7	1-1/2	5.0	0.2 / 0.8HP, 460V 3PH	196
MT SERIES MOTORIZED TROLLEY - 460V 3-PHASE - 5-TON										
144190	MT500-4	5	11,000	20 / 79	5-7	78.7	1-3/4	5.0	0.2 / 0.8HP, 460V 3PH	196

TROLLEY EXTENSION KIT ACCESSORIES

STOCK NUMBER	RANGE OF ADJUSTMENT
MT050-A08AB	5 - 8-1/4
MT050-A08AC	8-1/3 - 12-1/5
MT100-A08AB	5 - 8-1/4
MT100-A08AC	8-1/3 - 12-1/5
MT200-A08AB	6 - 8-6/7
MT200-A08AC	8-8/9 - 12-1/5
MT300-A12AB	7 - 9-5/6
MT300-A12AC	9-7/8 - 12-1/5
MT500-A12AB	7 - 9-5/6
MT500-A12AC	9-7/8 - 12-1/5



TS SERIES HOIST WITH MT TROLLEY DIMENSIONS

HOIST	TROLLEY	A	B	C	D	E	H1	H2
TS050	MT050	15-1/6	5	12-4/5	7	3-5	19-2/3	—
TS100	MT100	15-1/6	5	12-4/5	7	3-5	21	—
TS200	MT200	15-5/9	6-1/4	14-1/6	7-2/7	4-6	38-1/5	—
TS300	MT300	17-1/2	7-2/7	15-3/4	7-2/3	5-6 8/9	—	39-3/8
TS500	MT500	17-1/2	7-2/7	15-3/4	7-2/3	5-6 8/9	—	41-1/3
TS050-4	MT050	15-1/6	5	12-4/5	7	3-5	19-2/3	—
TS100-4	MT100	15-1/6	5	12-4/5	7	3-5	21	—
TS200-4	MT200	15-5/9	6-1/4	14-1/6	7-2/7	4-6	38-1/5	—
TS300-4	MT300	17-1/2	7-2/7	15-3/4	7-2/3	5-6 8/9	—	39-3/8
TS500-4	MT500	17-1/2	7-2/7	15-3/4	7-2/3	5-6 8/9	—	41-1/3

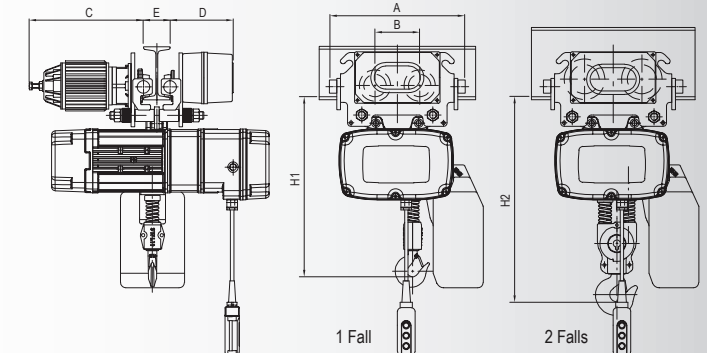



JSH SERIES ELECTRIC HOISTS

JSH SERIES ELECTRIC HOISTS

SAFETY

- Slip clutch overload protection mechanism that prevents the hoist from lifting damaging loads above its rated capacity
- Magnetic disk brake increases safety by ensuring rapid stops and securing the load
- Upper and lower limiting switches increase safety by preventing the load chain from over traveling
- This product complies with ANSI/ASME B30.16 and HST-1 Standards

DURABILITY

- Built-in thermal overload protection system that keeps the hoist from overheating
- Maintenance-free gear train incorporates a sealed oil bath, eliminating maintenance
- Grade 80 black oxide coated load chain for durability
- Heat treated alloy steel geared drive train for long lasting durability

STANDARD EQUIPMENT

- Heavy-duty nylon chain bag with reinforcing metal brackets
- 24-volt 2-button push-button controller is 2' less than lift

VERSATILITY

- Die cast Aluminum housing keeps the hoist lightweight and easily portable
- Available in 1/8-Ton and 1/4-Ton capacities with standard lifts of 10, 15, and 20 feet (custom lifts available)
- Load tested to 125% of capacity with certificate



JSH SERIES ELECTRIC HOISTS

STOCK NUMBER	MODEL NUMBER	CAPACITY (T)	LIFT (ft.)	LIFTING SPEED (fpm)	MOTOR	HEADROOM (in.)	DUTY CYCLE RATING	LOAD CHAIN (dia/mm) X NO. OF FALLS	MAX. ON TIME MIN. / HR.	MAX. NO. STARTS / HR.	WEIGHT (lbs.)
JSH ELECTRIC HOISTS - SINGLE SPEED 1 PHASE - 1/8 TON											
110100	JSH-275-10	1/8	10	16	3/16 HP, 115V, 1 Ph	15-1/4	H3	4 x 1	15	150	31
110115	JSH-275-15	1/8	15	16	3/16 HP, 115V, 1 Ph	15-1/4	H3	4 x 1	15	150	32
110120	JSH-275-20	1/8	20	16	3/16 HP, 115V, 1 Ph	15-1/4	H3	4 x 1	15	150	34
JSH ELECTRIC HOISTS - SINGLE SPEED 1 PHASE - 1/4 TON											
110110	JSH-550-10	1/4	10	8	3/16 HP, 115V, 1 Ph	17-1/8	H3	4 x 2	15	150	35
110515	JSH-550-15	1/4	15	8	3/16 HP, 115V, 1 Ph	17-1/8	H3	4 x 2	15	150	37
110520	JSH-550-20	1/4	20	8	3/16 HP, 115V, 1 Ph	17-1/8	H3	4 x 2	15	150	40

*CUSTOM LIFTS AVAILABLE IN ALL CAPACITIES IN 5 FT. INCREMENTS

JSH SERIES HOIST DIMENSIONS (IN.)

CAPACITY	A	B	C	D	E	F	G	H MIN.
1/8 TON	5	5-1/8	1-11/16	1	1-1/8	1-5/16	1-3/8	11
1/4 TON	5-5/16	6-1/8	2	1-3/16	1-5/16	1-5/8	1-13/16	12

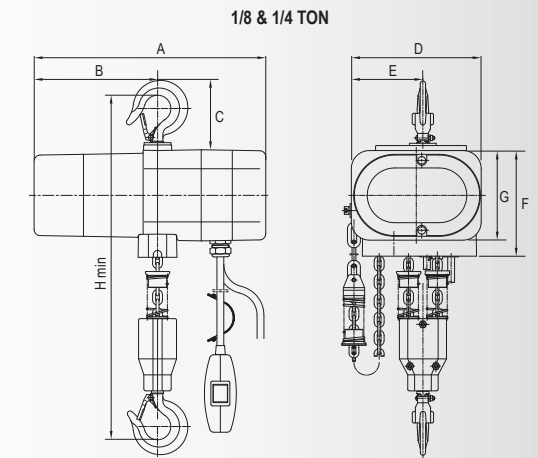



SSC SERIES ELECTRIC HOISTS

SSC SERIES ELECTRIC HOISTS



SAFETY

- All SSC Series electric hoists have a slip clutch style overload protection that prevents the hoist from lifting damaging loads above its rated capacity
- DC Electromagnetic brake design is an industry-proven safety feature that secures the load even if power is interrupted to the hoist
- Upper and lower limiting switches increase safety by preventing the load chain from over traveling
- Thermal Overload Protection protects the hoist from overheating in low voltage situations

DURABILITY

- Fully enclosed, all steel plate construction and powder coat finish keeps out dust and debris lengthening the life of the hoist
- Grade 80 black oxide coated load chain for added durability
- Sealed oil bath gear train reduces hoist maintenance

STANDARD EQUIPMENT

- Heavy-duty nylon chain bag with reinforcing metal brackets
- 24-volt 2-button push-button controller is 2' less than lift

STANDARDS

- This product complies with ANSI / ASME B30.16 and HST-1 Standards
- Load tested to 125% of capacity with certificate
- Push button control pendants are NEMA 4x compliant

SSC SERIES ELECTRIC HOISTS - 1 PHASE

STOCK NUMBER	MODEL NUMBER	CAPACITY (T)	LIFT (ft.)	LIFTING SPEED (fpm)	MOTOR (PREWIRED TO HIGHER VOLTAGE)	RATED AMPS 115V	RATED AMPS 230V	HEADROOM (in.)	DUTY CYCLE RATING	LOAD CHAIN (dia/mm) X NO. OF FALLS	MAX ON TIME MIN. / HR.	MAX. NO. STARTS / HR.	WEIGHT (lbs.)
SSC ELECTRIC HOISTS - SINGLE SPEED 1 PHASE - 1/2 TON													
121100	1/2SS-1C-10	1/2	10	19.7	7/8 HP, 230V, 1 Ph.	12.6	6	20-3/16	H3	6.3 x 1	15	150	102
121150	1/2SS-1C-15	1/2	15	19.7	7/8 HP, 230V, 1 Ph.	12.6	6	20-3/16	H3	6.3 x 1	15	150	106
121200	1/2SS-1C-20	1/2	20	19.7	7/8 HP, 230V, 1 Ph.	12.6	6	20-3/16	H3	6.3 x 1	15	150	109
SSC ELECTRIC HOISTS - SINGLE SPEED 1 PHASE - 1 TON													
111000	1SS-1C-10	1	10	19.7	1-3/4 HP, 230V, 1 Ph	20.8	10	24-7/16	H3	8 x 1	15	150	161
111500	1SS-1C-15	1	15	19.7	1-3/4 HP, 230V, 1 Ph	20.8	10	24-7/16	H3	8 x 1	15	150	166
112000	1SS-1C-20	1	20	19.7	1-3/4 HP, 230V, 1 Ph	20.8	10	24-7/16	H3	8 x 1	15	150	176
SSC ELECTRIC HOISTS - SINGLE SPEED 1 PHASE - 2 TON													
211000	2SS-1C-10	2	10	9.8	1-3/4 HP, 230V, 1 Ph	20.8	10	28-1/8	H3	8 x 2	15	150	168
211500	2SS-1C-15	2	15	9.8	1-3/4 HP, 230V, 1 Ph	20.8	10	28-1/8	H3	8 x 2	15	150	179
212000	2SS-1C-20	2	20	9.8	1-3/4 HP, 230V, 1 Ph	20.8	10	28-1/8	H3	8 x 2	15	150	188
SSC ELECTRIC HOISTS - SINGLE SPEED 1 PHASE - 3 TON													
311000	3SS-1C-10	3	10	6.6	1-3/4 HP, 230V, 1 Ph	20.8	10	31-1/2	H3	8 x 3	15	150	199
311500	3SS-1C-15	3	15	6.6	1-3/4 HP, 230V, 1 Ph	20.8	10	31-1/2	H3	8 x 3	15	150	214
312000	3SS-1C-20	3	20	6.6	1-3/4 HP, 230V, 1 Ph	20.8	10	31-1/2	H3	8 x 3	15	150	227
SSC ELECTRIC HOISTS - SINGLE SPEED 1 PHASE - 5 TON													
511000	5SS-1C-10	5	10	4.9	1-3/4 HP, 230V, 1 Ph	22	10.5	30-11/16	H3	8 x 4	15	150	218
511500	5SS-1C-15	5	15	4.9	1-3/4 HP, 230V, 1 Ph	22	10.5	30-11/16	H3	8 x 4	15	150	238
512000	5SS-1C-20	5	20	4.9	1-3/4 HP, 230V, 1 Ph	22	10.5	30-11/16	H3	8 x 4	15	150	258

SSC SERIES ELECTRIC HOISTS - 3 PHASE

STOCK NUMBER	MODEL NUMBER	CAPACITY (T)	LIFT (ft.)	LIFTING SPEED (fpm)	MOTOR (PREWIRED TO HIGHER VOLTAGE)	RATED AMPS 230V	RATED AMPS 460V	HEADROOM (in.)	DUTY CYCLE RATING	LOAD CHAIN (dia/mm) X NO. OF FALLS	MAX ON TIME MIN. / HR.	MAX. NO. STARTS / HR.	WEIGHT (lbs.)
SSC ELECTRIC HOISTS - SINGLE SPEED 3 PHASE - 1/2 TON													
123100	1/2SS-3C-10	1/2	10	31.5	1-1/3 HP, 460V, 3 Ph	3.5	1.8	20-3/16	H3	6.3 x 1	18	180	102
123150	1/2SS-3C-15	1/2	15	31.5	1-1/3 HP, 460V, 3 Ph	3.5	1.8	20-3/16	H3	6.3 x 1	18	180	106
123200	1/2SS-3C-20	1/2	20	31.5	1-1/3 HP, 460V, 3 Ph	3.5	1.8	20-3/16	H3	6.3 x 1	18	180	109
SSC ELECTRIC HOISTS - SINGLE SPEED 3 PHASE - 1 TON													
131000	1SS-3C-10	1	10	24.8	2-1/8 HP, 460V, 3 Ph	5.9	3	24-7/16	H3	8 x 1	18	180	161
131500	1SS-3C-15	1	15	24.8	2-1/8 HP, 460V, 3 Ph	5.9	3	24-7/16	H3	8 x 1	18	180	166
132000	1SS-3C-20	1	20	24.8	2-1/8 HP, 460V, 3 Ph	5.9	3	24-7/16	H3	8 x 1	18	180	176
SSC ELECTRIC HOISTS - SINGLE SPEED 3 PHASE - 2 TON													
231000	2SS-3C-10	2	10	12.4	2-1/8 HP, 460V, 3 Ph	5.9	3	28-1/8	H3	8 x 2	18	180	168
231500	2SS-3C-15	2	15	12.4	2-1/8 HP, 460V, 3 Ph	5.9	3	28-1/8	H3	8 x 2	18	180	179
232000	2SS-3C-20	2	20	12.4	2-1/8 HP, 460V, 3 Ph	5.9	3	28-1/8	H3	8 x 2	18	180	188
SSC ELECTRIC HOISTS - SINGLE SPEED 3 PHASE - 3 TON													
331000	3SS-3C-10	3	10	8.3	2-1/8 HP, 460V, 3 Ph	5.9	3	31-1/2	H3	8 x 3	18	180	199
331500	3SS-3C-15	3	15	8.3	2-1/8 HP, 460V, 3 Ph	5.9	3	31-1/2	H3	8 x 3	18	180	214
332000	3SS-3C-20	3	20	8.3	2-1/8 HP, 460V, 3 Ph	5.9	3	31-1/2	H3	8 x 3	18	180	227
SSC ELECTRIC HOISTS - SINGLE SPEED 3 PHASE - 5 TON													
531000	5SS-3C-10	5	10	6.2	2-1/8 HP, 460V, 3 Ph	5.9	3	30-11/16	H3	8 x 4	18	180	218
531500	5SS-3C-15	5	15	6.2	2-1/8 HP, 460V, 3 Ph	5.9	3	30-11/16	H3	8 x 4	18	180	238
530200	5SS-3C-20	5	20	6.2	2-1/8 HP, 460V, 3 Ph	5.9	3	30-11/16	H3	8 x 4	18	180	258

*CUSTOM LIFTS AVAILABLE IN ALL CAPACITIES IN 5 FT. INCREMENTS

SSC SERIES HOIST DIMENSIONS (IN.)

CAPACITY	A	B	C	D	E	F	H MIN.
1/2 TON	17-3/4	9-13/16	4-1/16	10-1/4	4-7/16	9-7/16	20-3/16
1 TON	20-7/16	11-3/16	4-11/16	11-13/16	5-1/4	10-5/16	24-7/16
2 TON	20-7/16	11-3/16	5-3/16	11-13/16	4-7/16	10-15/16	28-1/8
3 TON	20-7/16	11-3/16	5-11/16	11-13/16	6-3/8	10-15/16	31-1/2
5 TON	20-7/16	11-3/16	6-9/16	11-13/16	8-1/4	10-15/16	30-11/16

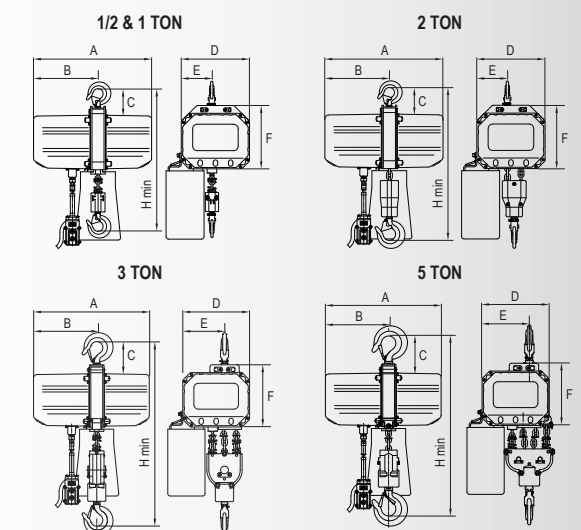

JCP SERIES CABLE PULLERS

FEATURES

- General purpose cable puller designed to lift, lower, stretch or pull heavy loads
- Double solid cast aluminum ratchet wheel brake system hold load securely in any position
- Lightweight zinc plated steel construction to resist corrosion
- Concealed spring lever control prevents accidental release
- Drop forged hooks with safety latches standard
- Snatch block included with JCP-2 and JCP-4 models
- Aircraft quality cable
- 1-ton to 4-ton capacities

STANDARDS

- This product complies with ANSI / ASME B30.21 Standards
- Load tested to 125% of capacity with certificate

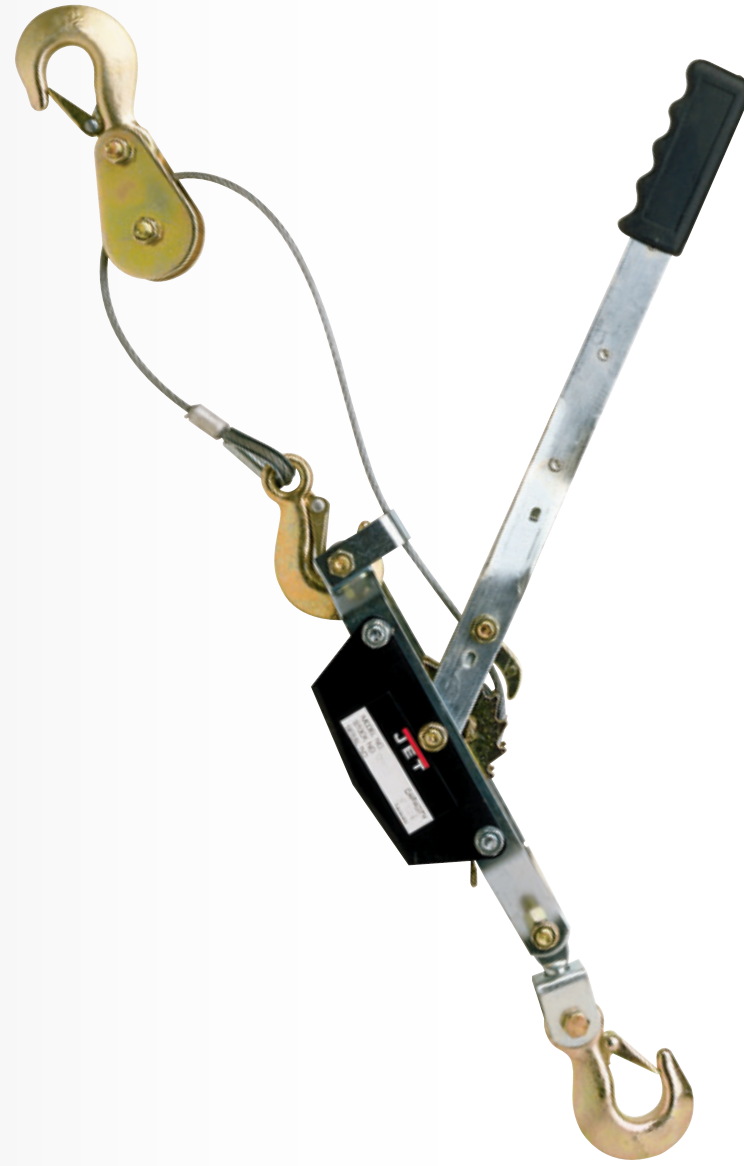

Stock# 180420 shown

STOCK NUMBER	180410	180420	180440
Model Number	JCP-1	JCP-2	JCP-4
Capacity (T)	1	2	4
Lever Ratio	18:1	36:1	36:1
Maximum Lift (ft.)	12	5	5
Lever Length (in.)	16-1/2	16-1/2	17-1/8
Minimum Distance Between Hooks (in.)	17	21	22
Wire Rope Diameter (in.)	3/16	3/16	1/4
Weight (lbs.)	7	9	13

JG SERIES GRIP PULLERS

FEATURES

- Industrial quality grip puller designed to lift, lower or pull heavy loads
- Easy to use in any direction, angle, length of pull or lift
- Multiple clutch brake system holds load in any position
- Safety shear pin in telescopic handle provides automatic overload protection
- Heavy-duty safety hooks with spring-loaded latches
- 3/4-ton to 3-ton pulling capacities
- Available with or without 66 ft. of wire rope

STANDARDS

- This product complies with ANSI / ASME B30.21 Standards



STOCK NUMBER WITH ROPE	286575K	286515K	286530K
Model Number	JG-75A	JG-150A	JG-300A
Pulling Capacity (lbs.)	2750	5500	11000
Lifting Capacity (lbs.)	1650	3300	6600
Handle Length (in.)	29-1/2	41	46-1/2
Distance Per Stroke (in.)	2-9/32	2-3/8	1-1/2
Wire Rope Diameter (in.)	5/16	7/16	5/8
Lifting Speed (fpm)	10	10	10
Overall Dimensions (L x W x H / in.)	16-3/4 x 2-1/2 x 9-1/4	21-1/2 x 3-7/8 x 11	26 x 4-1/2 x 12-3/4
Weight (lbs.)	36	48	123
STOCK NUMBER WITHOUT ROPE	286575	286515	286530

WIRE ROPE SPECIFICATIONS

STOCK NUMBER	MODEL NUMBER	DIAMETER (IN)	WEIGHT (LBS.)
286574	WR-75A	5/16	15
286514	WR-150A	7/16	28
286529	WR-300A	5/8	41



WHY CHOOSE JET LIFTING SYSTEMS



DEPENDABILITY

JET's limited lifetime warranty protects our products against manufacturing defects in workmanship and materials.

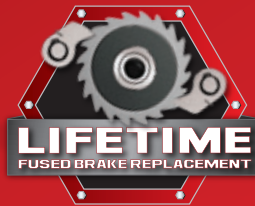

FUSED BRAKE REPLACEMENT

JET's revolutionary single-piece brake design fuses three components into the safest and most durable brake system in the market. JET is so confident in this design, we back it with a lifetime replacement warranty.



2-YEAR WARRANTY

JET Electric Hoists and Electric Hoist Accessories are covered by a 2-year warranty against any manufacturing defects in workmanship or materials.

Stock # 22-00718-v1

3/2023

©2023 JPW Industries

Printed In U.S.A.